



US006865447B2

(12) **United States Patent**
Lau et al.

(10) **Patent No.:** **US 6,865,447 B2**
(45) **Date of Patent:** **Mar. 8, 2005**

(54) **ROBOT CAPABLE OF DETECTING AN EDGE**

(75) Inventors: **Shek Fai Lau, Foster City, CA (US); John Paul Reeves, Hong Kong (HK)**

(73) Assignee: **Sharper Image Corporation, San Francisco, CA (US)**

(*) Notice: Subject to any disclaimer, the term of this patent is extended or adjusted under 35 U.S.C. 154(b) by 28 days.

(21) Appl. No.: **10/622,842**

(22) Filed: **Jul. 18, 2003**

(65) **Prior Publication Data**

US 2004/0059467 A1 Mar. 25, 2004

Related U.S. Application Data

(62) Division of application No. 10/284,110, filed on Oct. 30, 2002, now Pat. No. 6,611,734, which is a division of application No. 09/881,420, filed on Jun. 14, 2001, now Pat. No. 6,507,773.

(51) **Int. Cl.**⁷ **G05B 15/00; G05B 19/00**

(52) **U.S. Cl.** **700/258; 700/245; 345/156**

(58) **Field of Search** **700/258, 245, 700/247-250, 256, 259, 215; 318/568.11, 568.12, 568.13, 568.16, 568.21, 587; 901/36, 47**

(56) **References Cited**

U.S. PATENT DOCUMENTS

D251,628 S	4/1979	McQuarrie et al.	D21/150
D258,900 S	4/1981	Lanusse	D21/150
D262,643 S	1/1982	Wong	D21/150
D287,986 S	1/1987	Matsui	D21/150
4,654,659 A	3/1987	Kubo	340/825.76
D293,344 S	12/1987	Shiraishi	D21/150
4,717,364 A	1/1988	Furukawa	466/175
4,736,826 A	4/1988	White et al.	191/12.2 A

D297,749 S	9/1988	Rodis-Jamero	D21/150
5,095,577 A	3/1992	Jonas et al.	15/315
5,109,566 A	5/1992	Kobayashi et al.	15/319
5,634,237 A	6/1997	Paranjpe	15/319
5,841,259 A	11/1998	Kim et al.	318/587
5,940,930 A	8/1999	Oh et al.	15/355
D437,368 S	2/2001	Tsai	D21/637
6,243,623 B1	6/2001	Takenaka et al.	700/245
6,266,576 B1	7/2001	Okada et al.	700/245
6,289,265 B1	9/2001	Takenaka et al.	700/245
6,317,652 B1	11/2001	Osada	700/245
6,370,453 B2	4/2002	Sommer	701/23
6,374,157 B1	4/2002	Takamura	700/245
6,415,203 B1	7/2002	Inoue et al.	700/245
6,457,206 B1	10/2002	Judson	15/320
6,459,955 B1 *	10/2002	Bartsch et al.	700/245
6,507,773 B2	1/2003	Parker et al.	700/258

(List continued on next page.)

OTHER PUBLICATIONS

Colombo et al., Affine visual servoing: a framework for relative positioning with a robot, 1995, IEEE, pp. 21-27.*

(List continued on next page.)

Primary Examiner—Thomas G. Black

Assistant Examiner—McDiciunel Marc

(74) *Attorney, Agent, or Firm*—Fliesler Meyer LLP

(57) **ABSTRACT**

A robot which incorporates a body, and sensors that allow the robot to interact with objects in the room, and prevents the robot from traveling off an edge or bumping into obstacles. A driving mechanism moves the robot along a surface. An edge detection system includes a plurality of infrared emitters each directed at a different angle with respect to the surface. The emitters alternately emitting signals such that only one of the emitters emits a signal at one time. A signal receiving device detects signals emitted by the infrared emitters after the signals have been reflected. The edge detection system detects an edge based on feedback received from the signal receiving device.

40 Claims, 17 Drawing Sheets

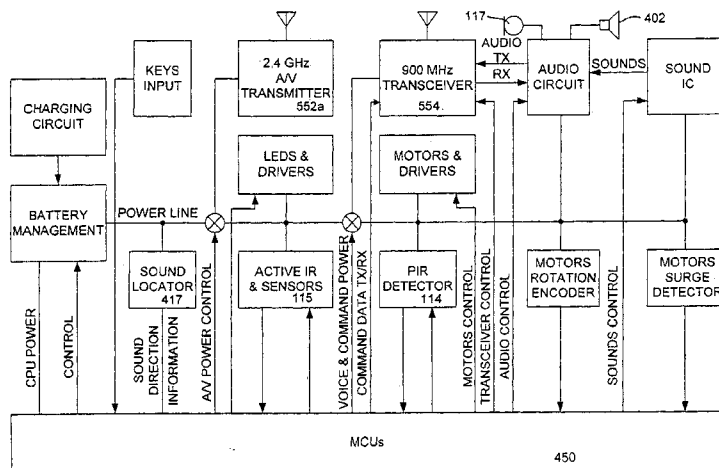

U.S. PATENT DOCUMENTS

6,519,506	B2	2/2003	Osawa	700/245
6,522,329	B1	2/2003	Ihara et al.	345/441
6,594,551	B2 *	7/2003	McKinney, Jr. et al.	700/258
6,604,022	B2 *	8/2003	Parker et al.	700/258
6,611,734	B2	8/2003	Parker et al.	700/258
2001/0047226	A1	11/2001	Saijo et al.	
2002/0036617	A1 *	3/2002	Pryor	345/156
2002/0193908	A1 *	12/2002	Parker et al.	700/258
2003/0009261	A1 *	1/2003	Parker et al.	700/258
2004/0046736	A1 *	3/2004	Pryor et al.	345/156

OTHER PUBLICATIONS

Chen et al., Edge tracking using tactile servo, 1995, IEEE, pp. 84-89.*

Hague et al., Autonomous robot navigation for precision horticulture, 1997, IEEE, pp. 20-25.*

Yoshihiro Kuroki, "A Small Biped Entertainment Robot," 2001 International Symposium on Micromechatronics and Human Science 0-7803-7190-9/01 © 2001 IEEE.

B. Mohamed, F. Gravez, F.B. Ouedzou, "Emulation of the Human Torso Dynamic Effects During Walking Gait," IEEE International Workshop on Robot and Human Interactive Communication 0-7803-7222-0/01 © 2000 IEEE.

P. Sardain and G. Bessonnet, "Gait Analysis of a Human Walker wearing Robot Feet as Shoes," Proceeding of the 2001 IEEE International Conference on Robotics & Automation, Seoul, Korea, May 21-26, 2001, 0-7803-6475-9/01© 2001 IEEE.

Hiroshi Ishiguro, Tetsuo Ono, Michita Imai, Takeshi Maeda, Takayuki Kanda, Ryohei Nakatsu, Robovie: A robot generates episode chains in our daily life, Proceedings of the 32nd ISR (International Symposium on Robotics), Apr. 19-21, 2001.

"Introducing the iRobot-LE™", iRobot Corporation: The iRobot-LE, <http://www.irobot.com/ir/index.htm>, downloaded Dec. 5, 2000, 1 page.

"Here are just a few of the uses of the iRobot-LE™," iRobot Corporation: The iRobot-LE: Many uses, http://www.irobot.com/ir/iR_many_uses.htm, downloaded Dec. 5, 2000, 2 pages.

"The Package", iRobot Corporation: The iRobot-LE: the Package, http://www.irobot.com/ir/iR_package.htm, downloaded Dec. 5, 2000, 2 pages.

The Power to Transport Yourself Anywhere in the World, iRobot Corporation: The iRobot-LE: Take Control, http://www.irobot.com/ir/iR_take_control.htm, downloaded Dec. 5, 2000, 2 pages.

"All You Need is a High Speed Internet Connection", iRobot Corporation: The iRobot-LE: Requirements, http://www.irobot.com/ir/iR_requirements.htm, downloaded Dec. 5, 2000, 2 pages.

Questions and Answers About the iRobot-LE™, iRobot Corporation: The iRobot-LE: Questions and Answers, <http://www.irobot.com/ir/qa.htm>, downloaded Dec. 5, 2000, 6 pages.

"iRobot-LE™ Technical Specifications", iRobot Corporation: The iRobot-LE: Technical Specifications, <http://www.irobot.co./ir/tech.htm>, downloaded Dec. 5, 2000, 2 pages.

Hamilton, Anita, "Robots Take Over Toyland", Time for Kids, Feb. 23, 2001, p. 7.

Goldman, Lee, "Keeping Up with the Jetsons," Forbes, Oct. 16, 2000, 1 page (p. 248).

* cited by examiner

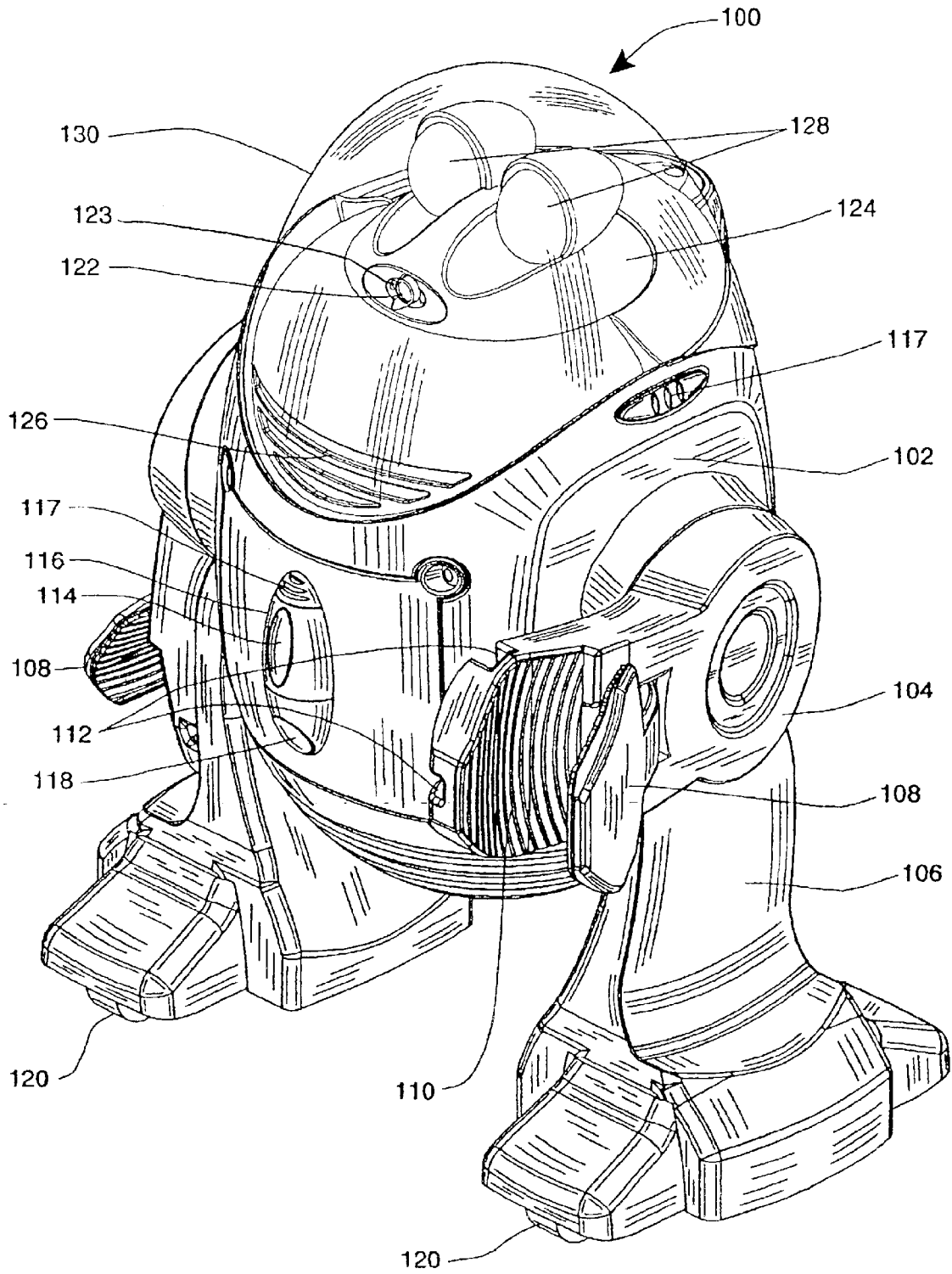

FIG. 1

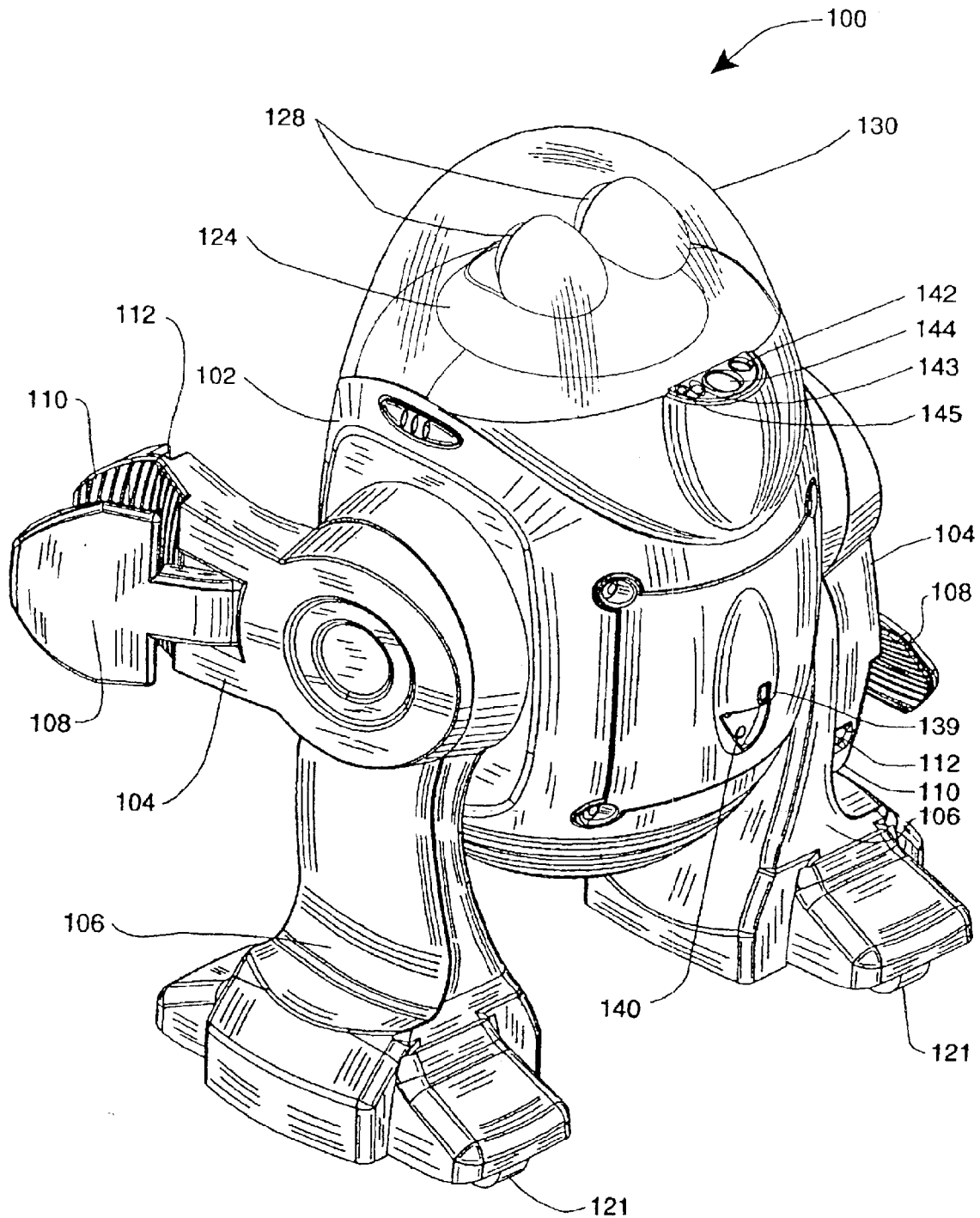

FIG. 2

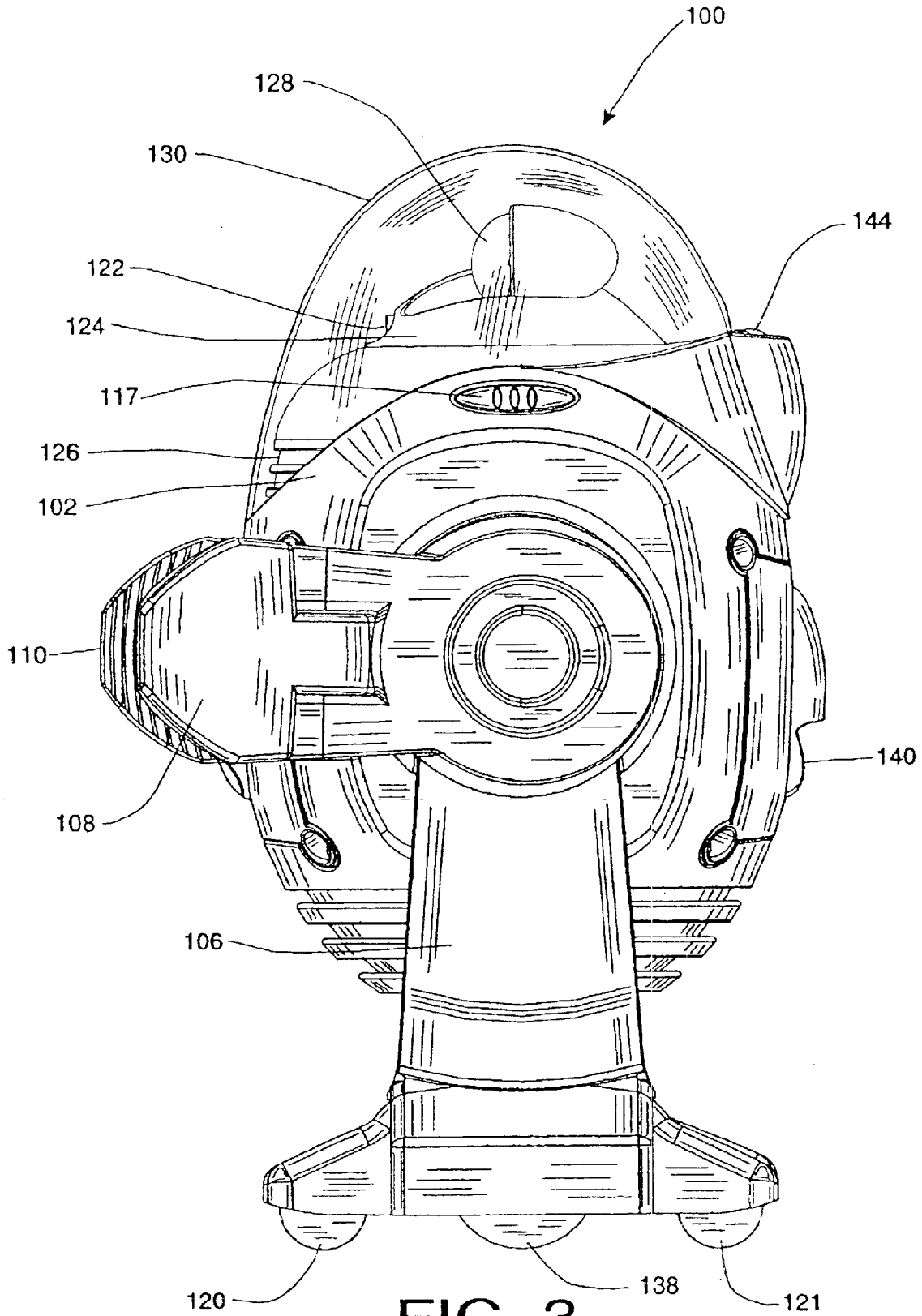

FIG. 3

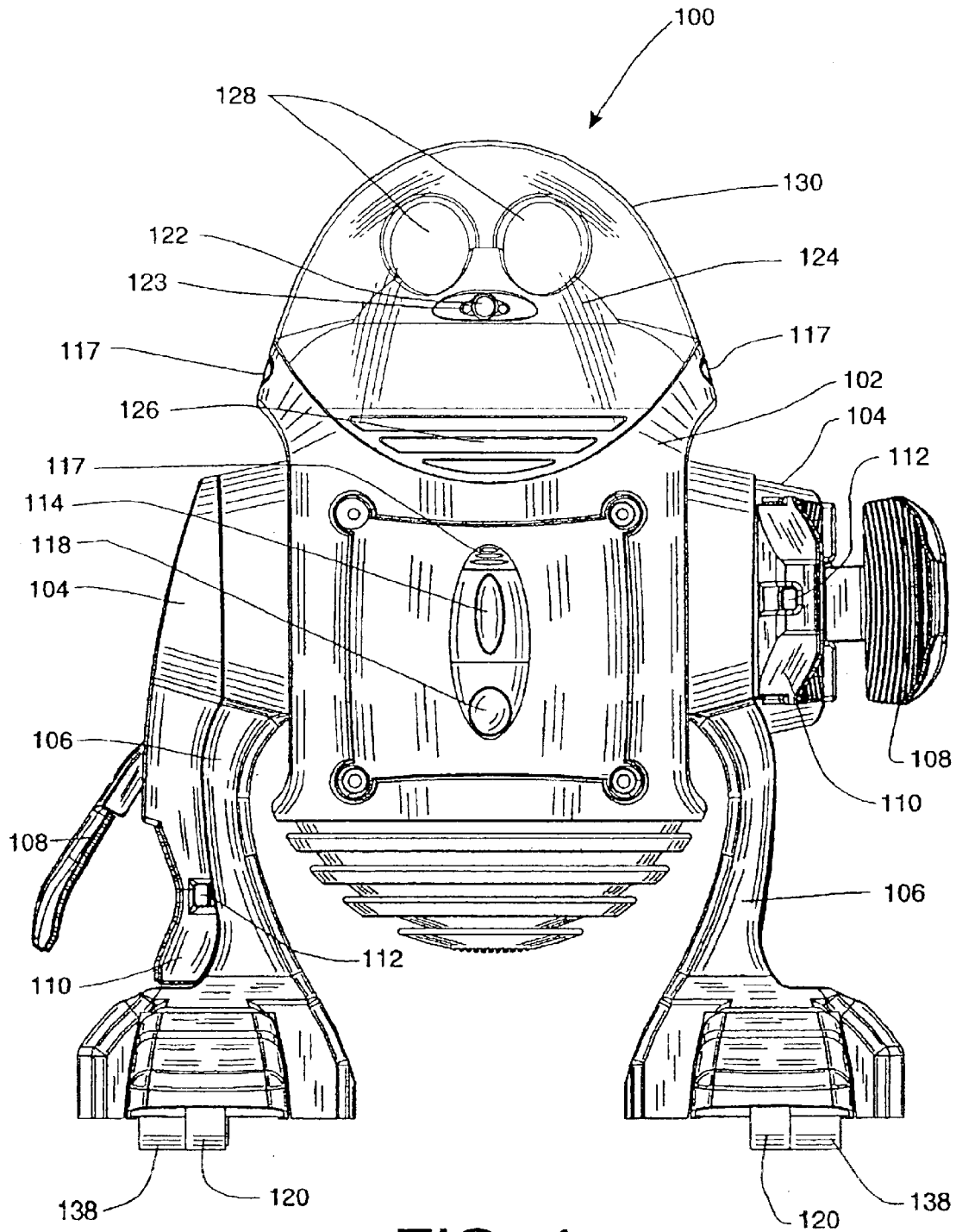

FIG. 4

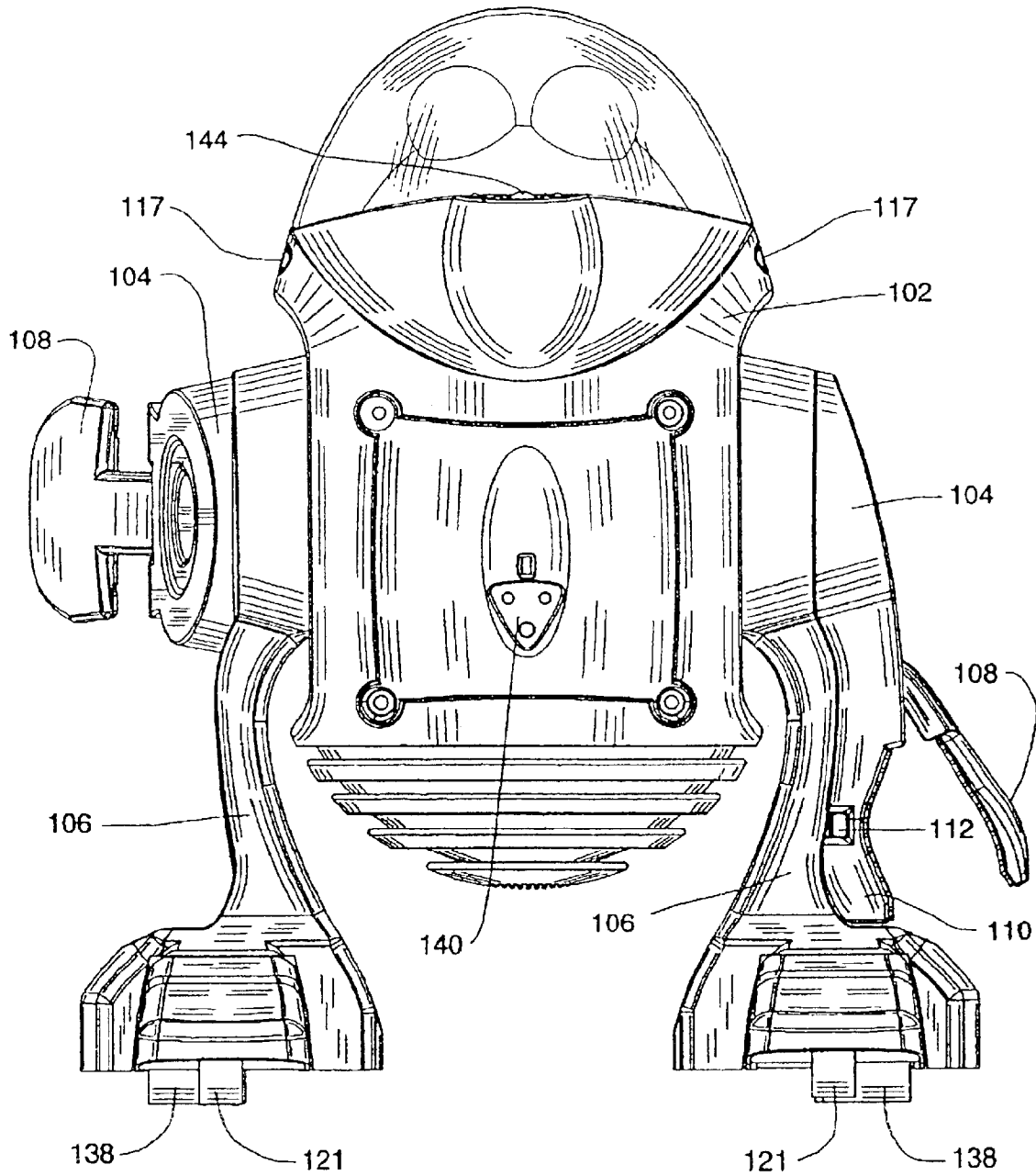

FIG. 5

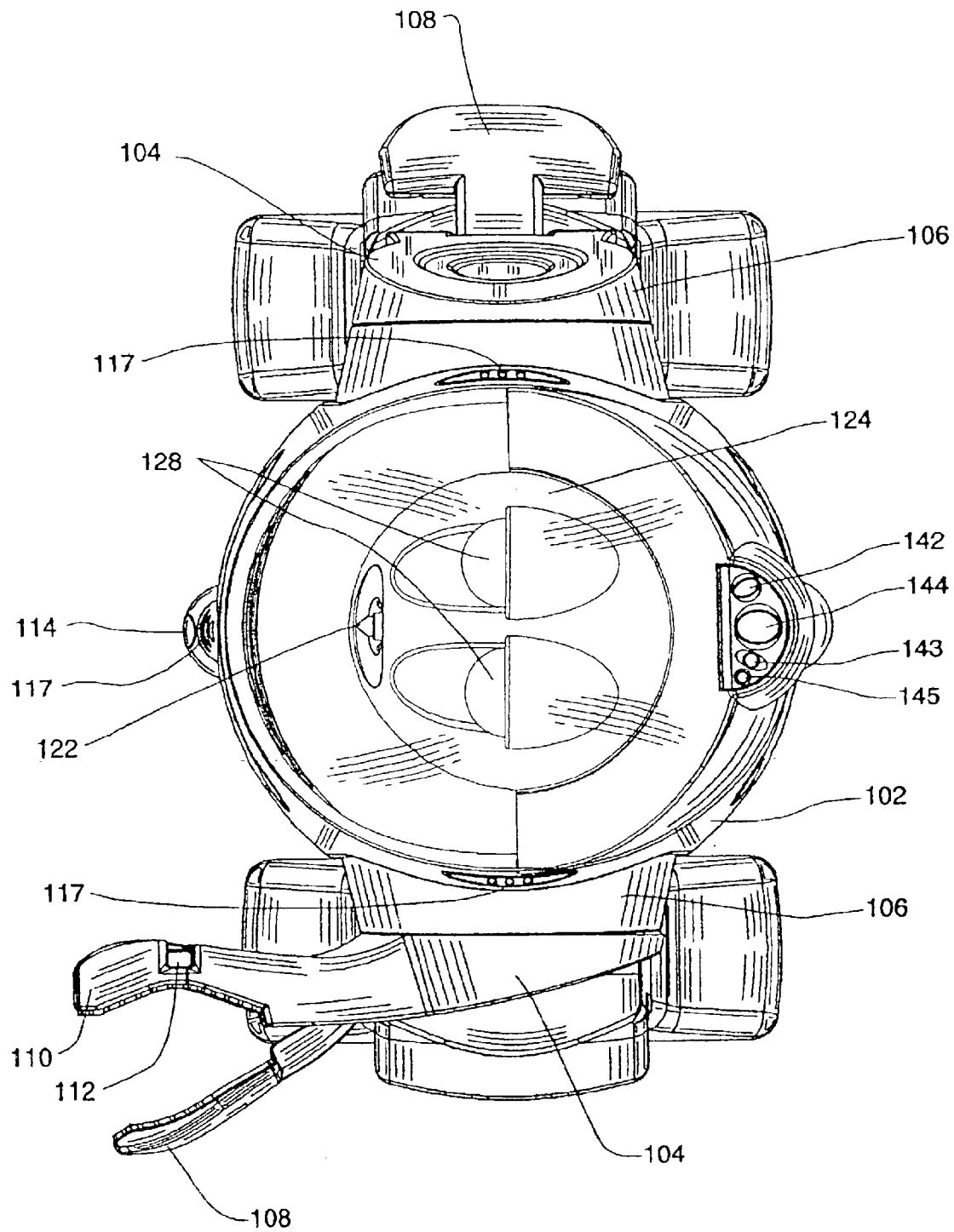

FIG. 6

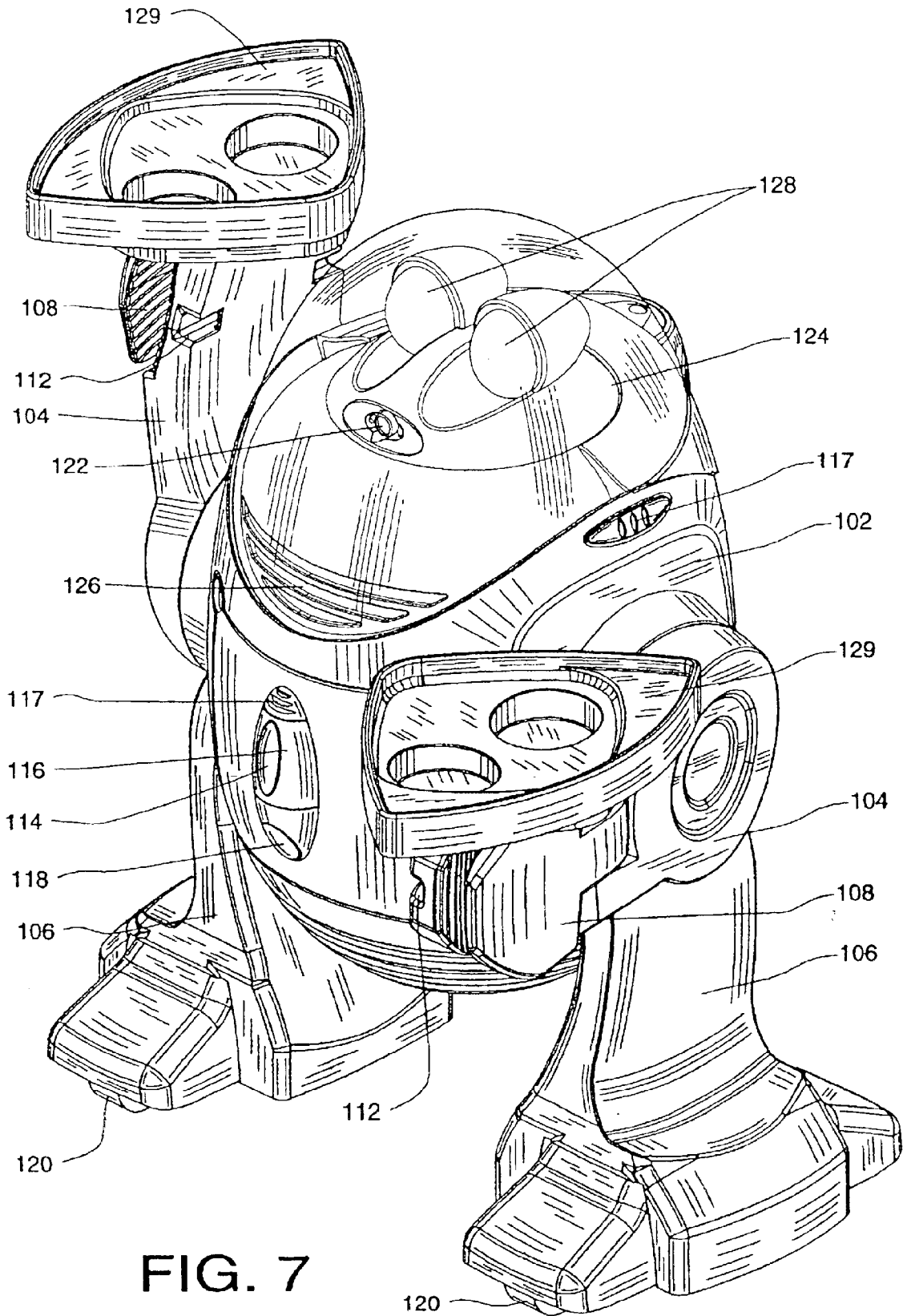

FIG. 7

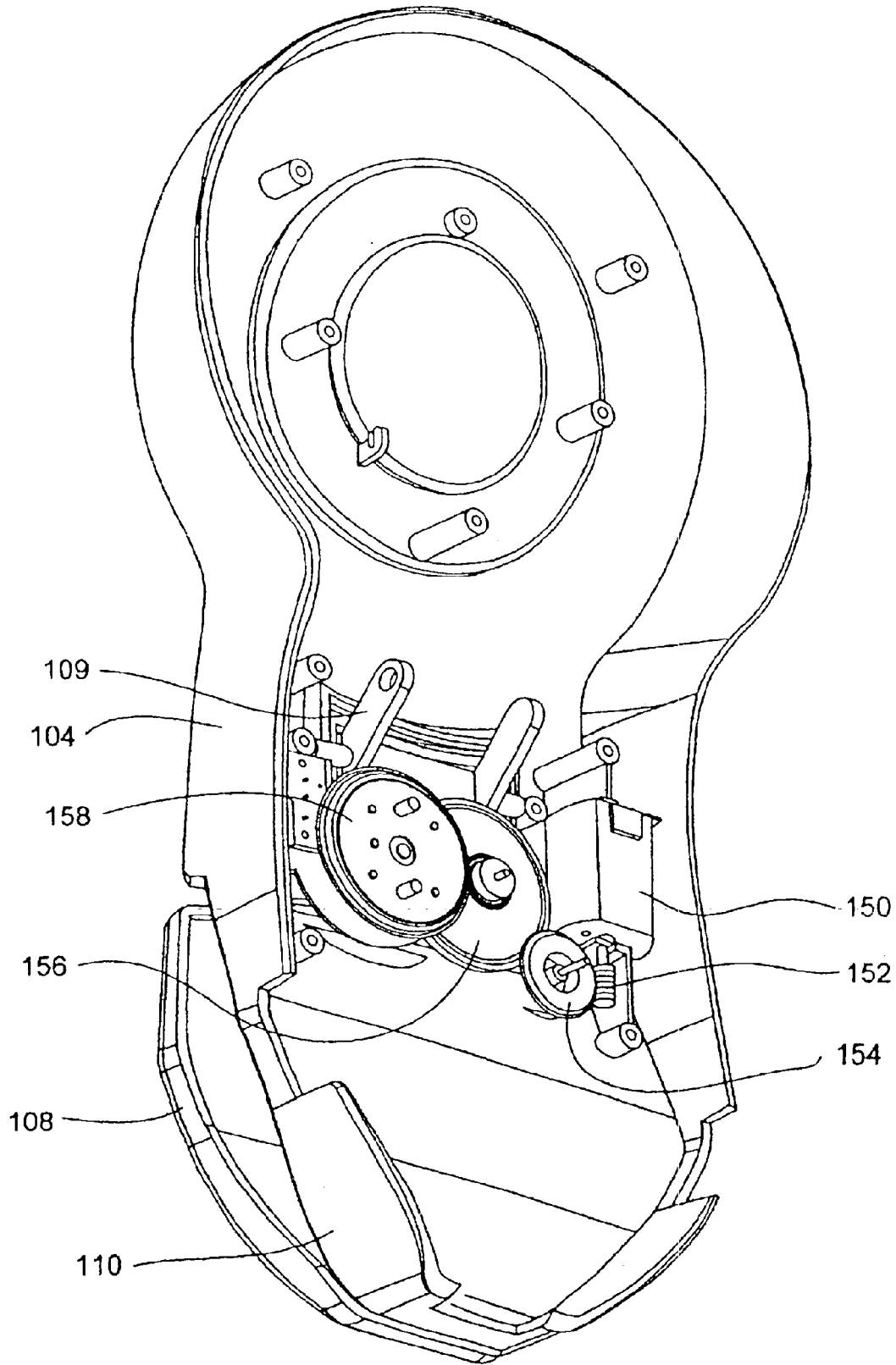

FIG. - 8

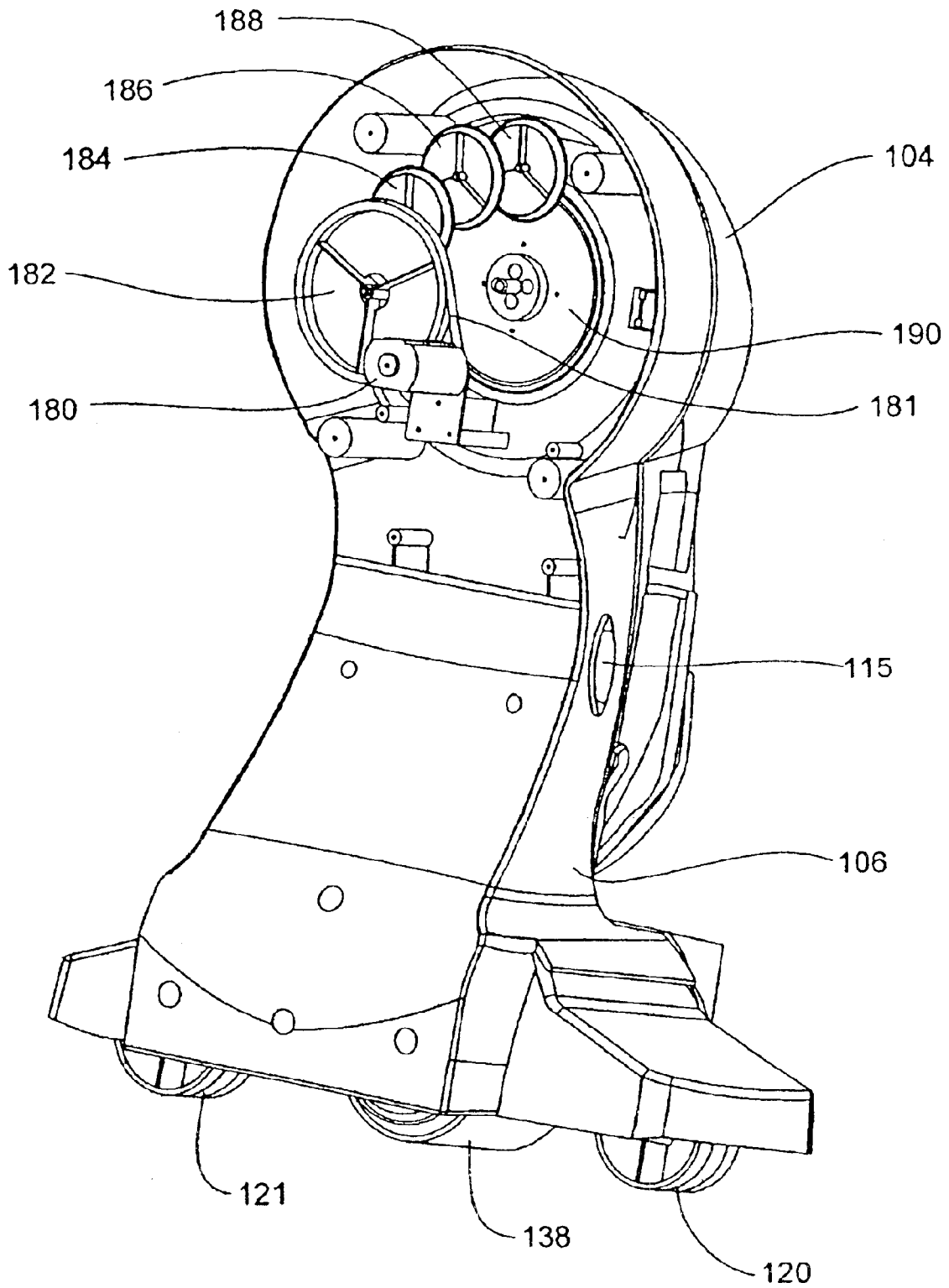

FIG. - 9

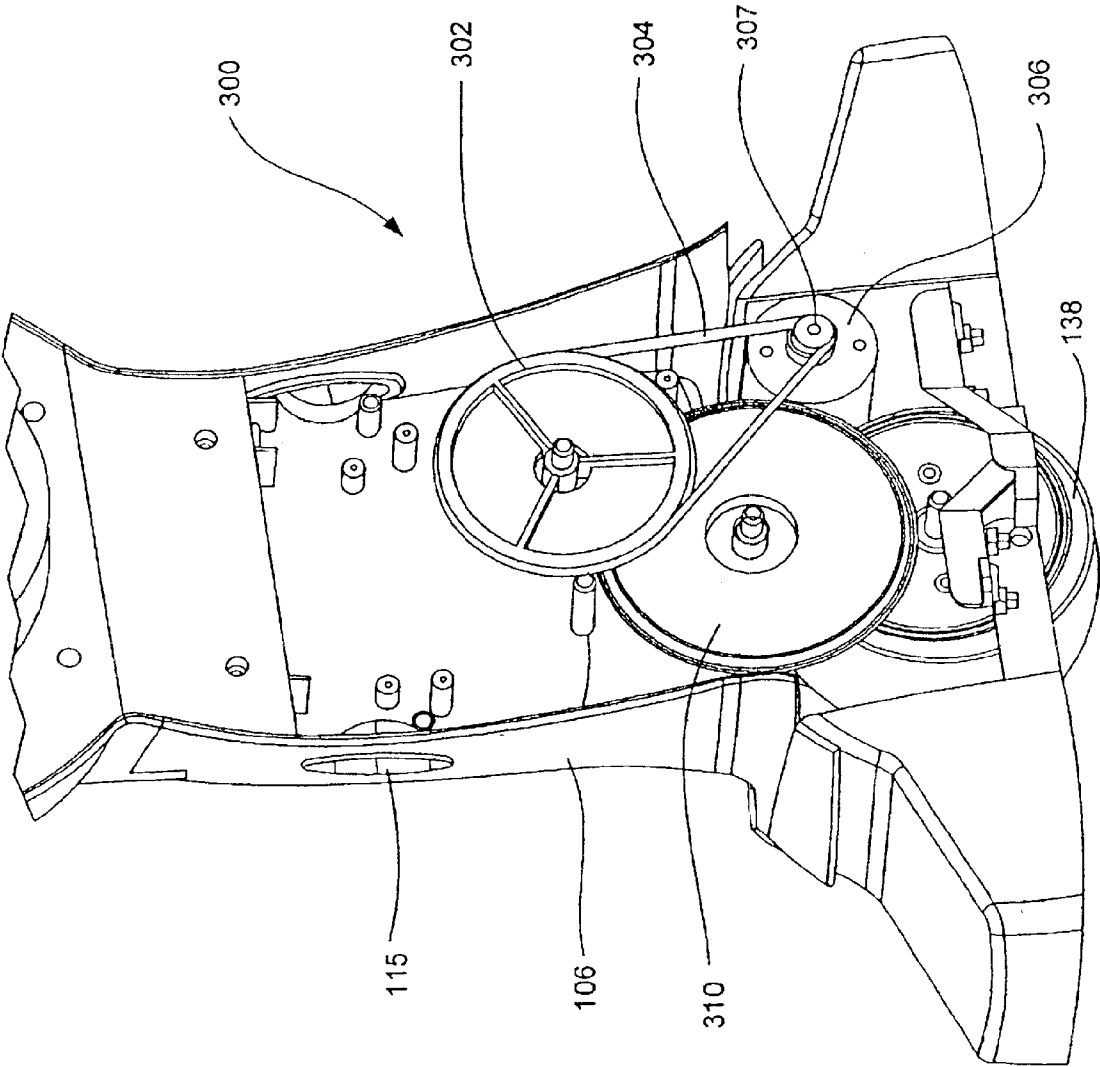
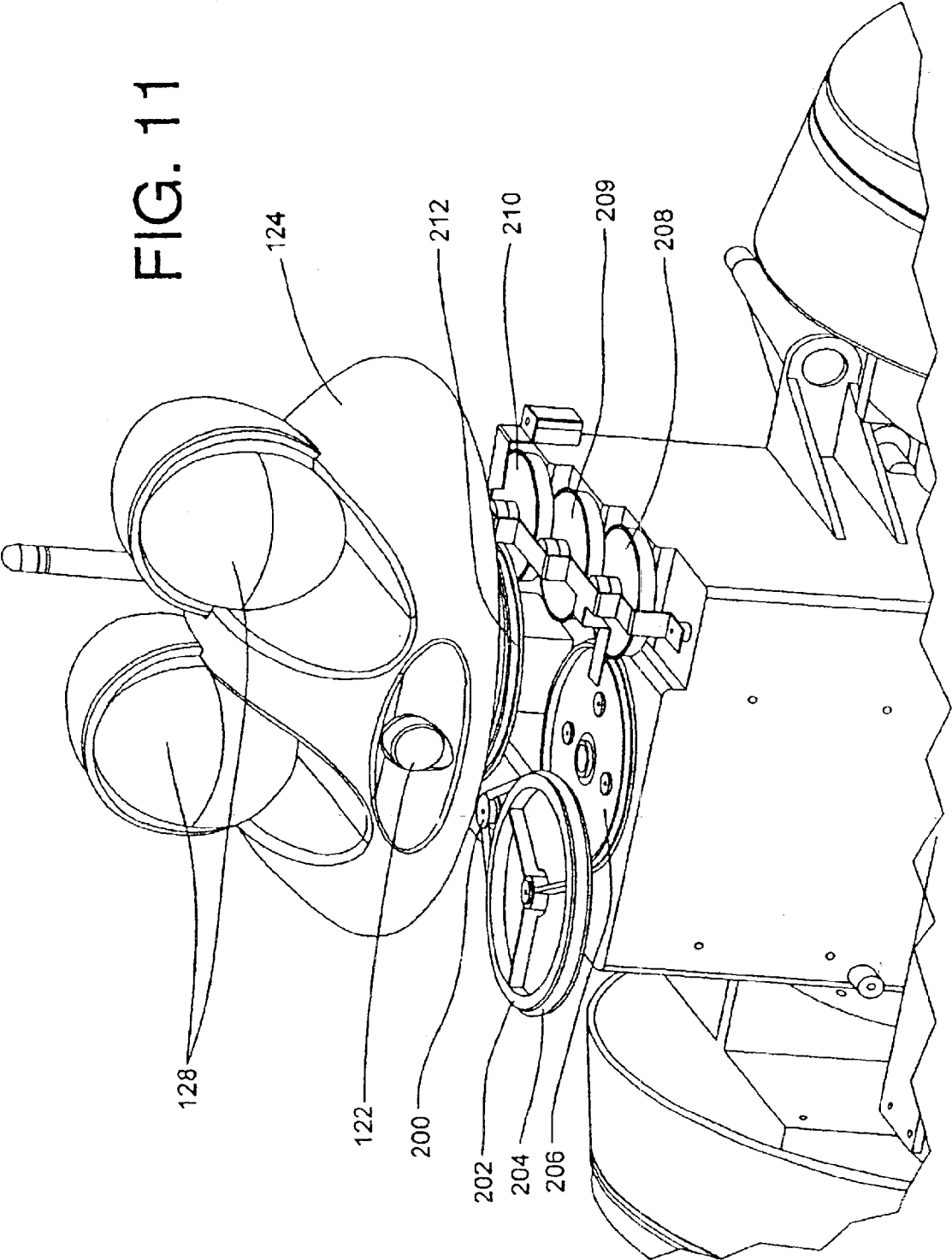

FIG. 10

FIG. 11



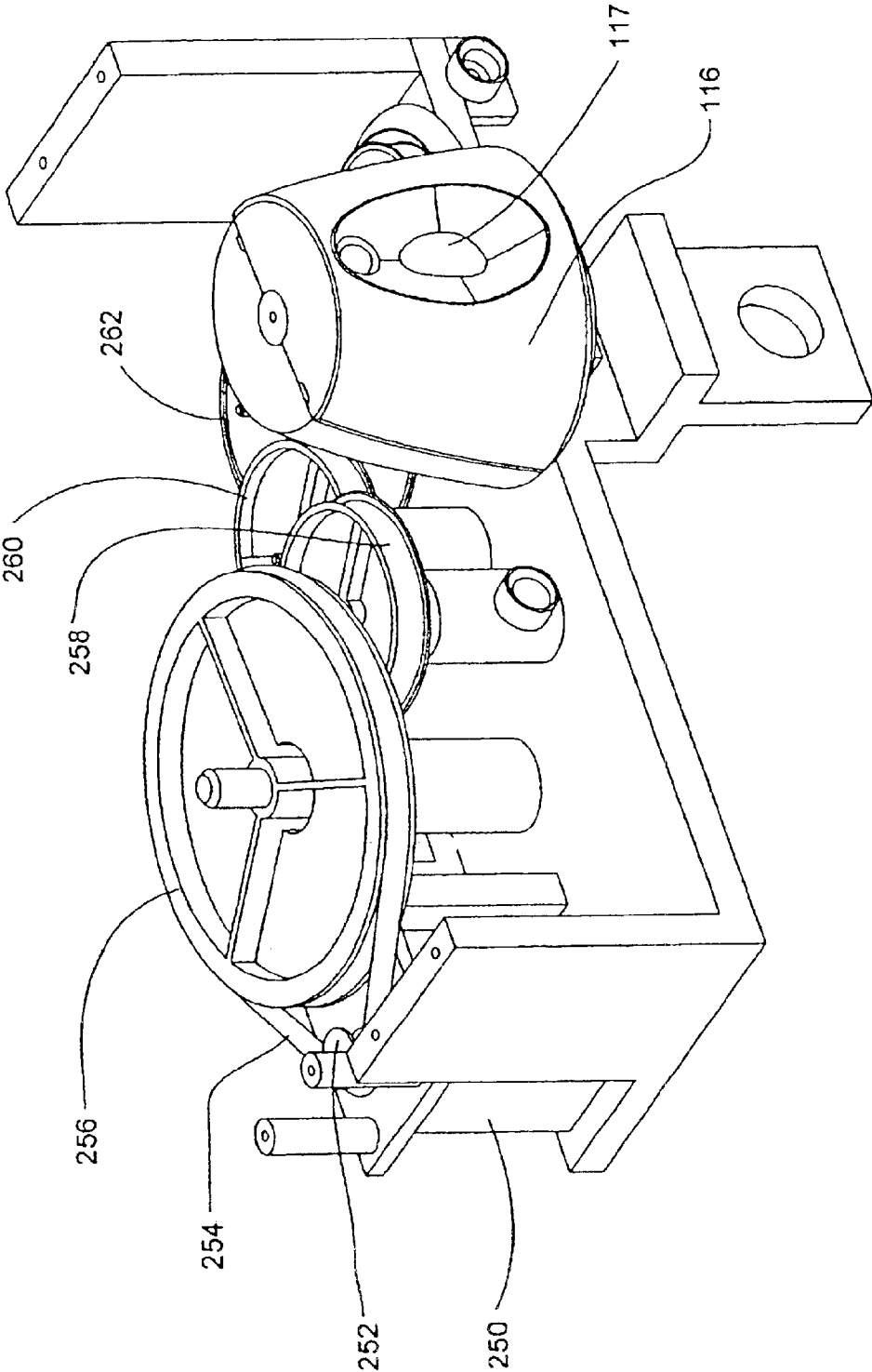

FIG. 12

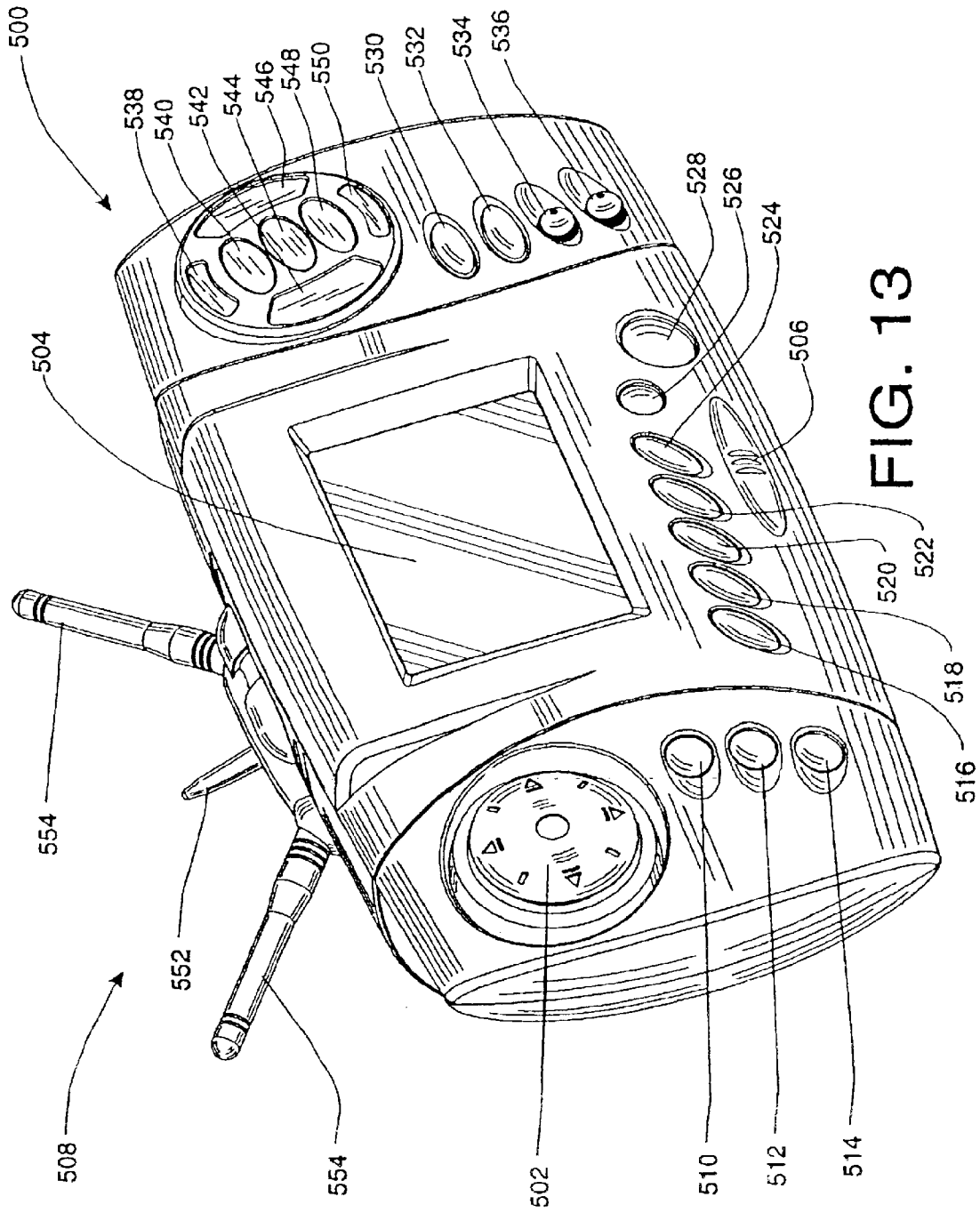

FIG. 13

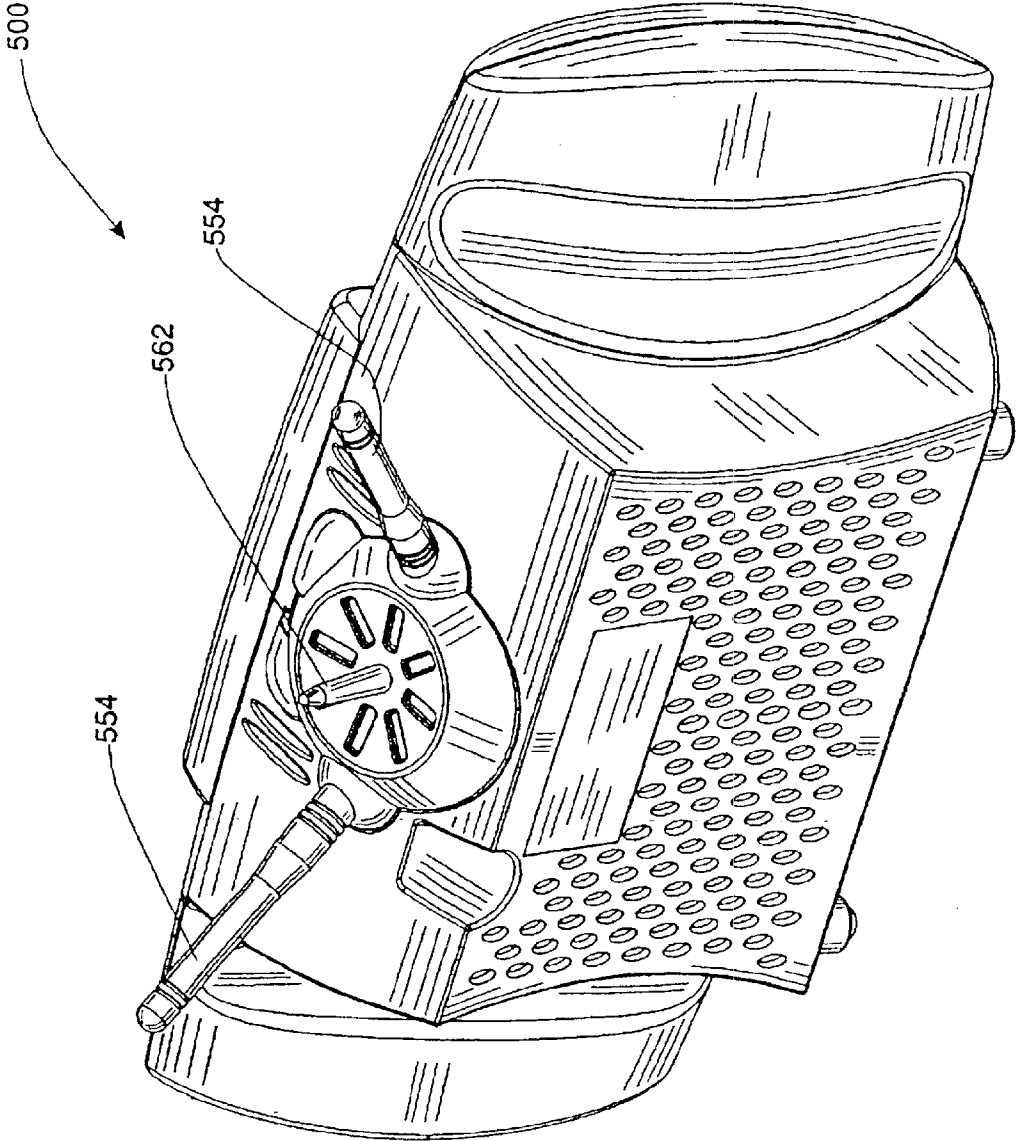

FIG. 14

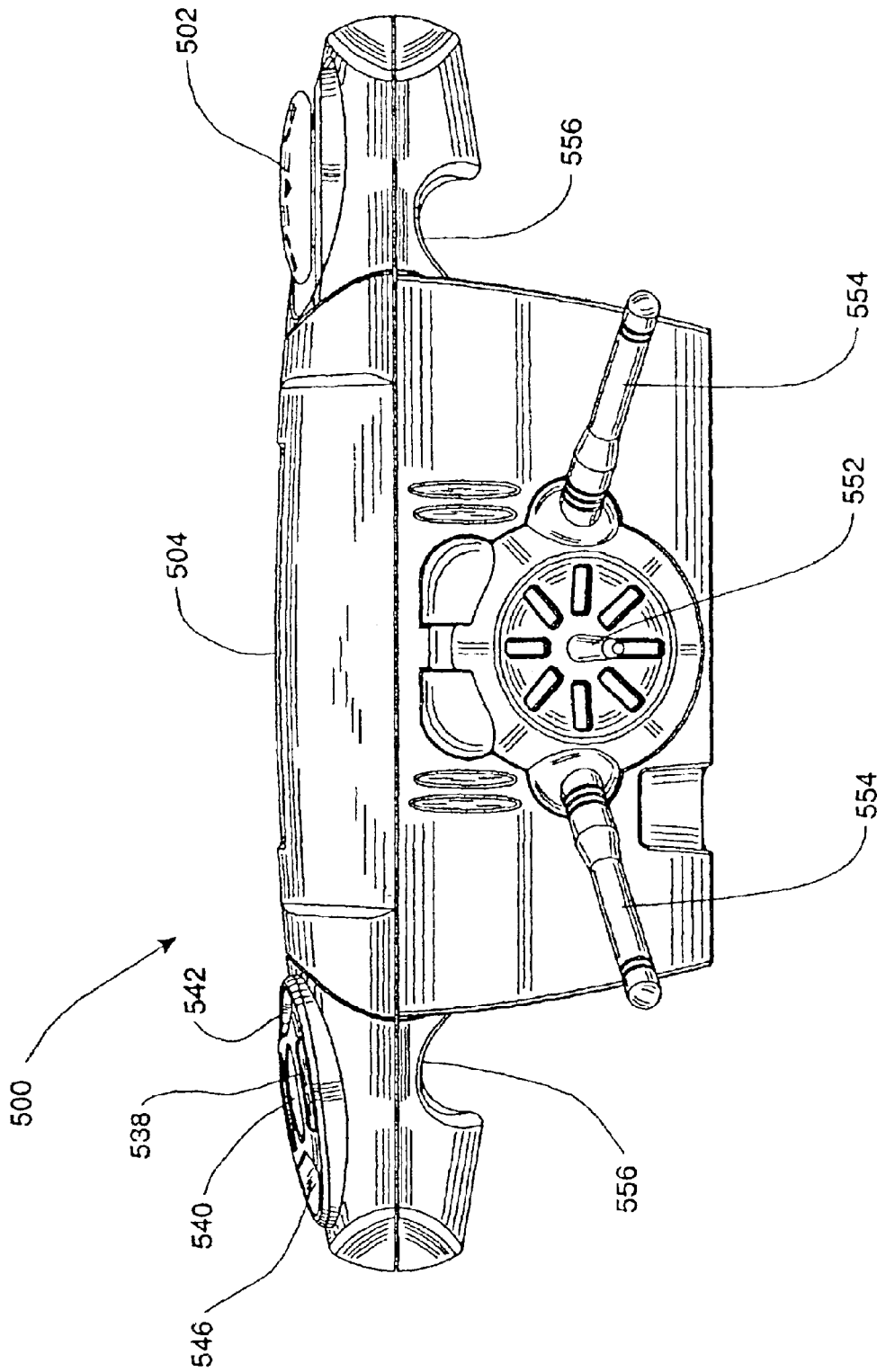

FIG. 15

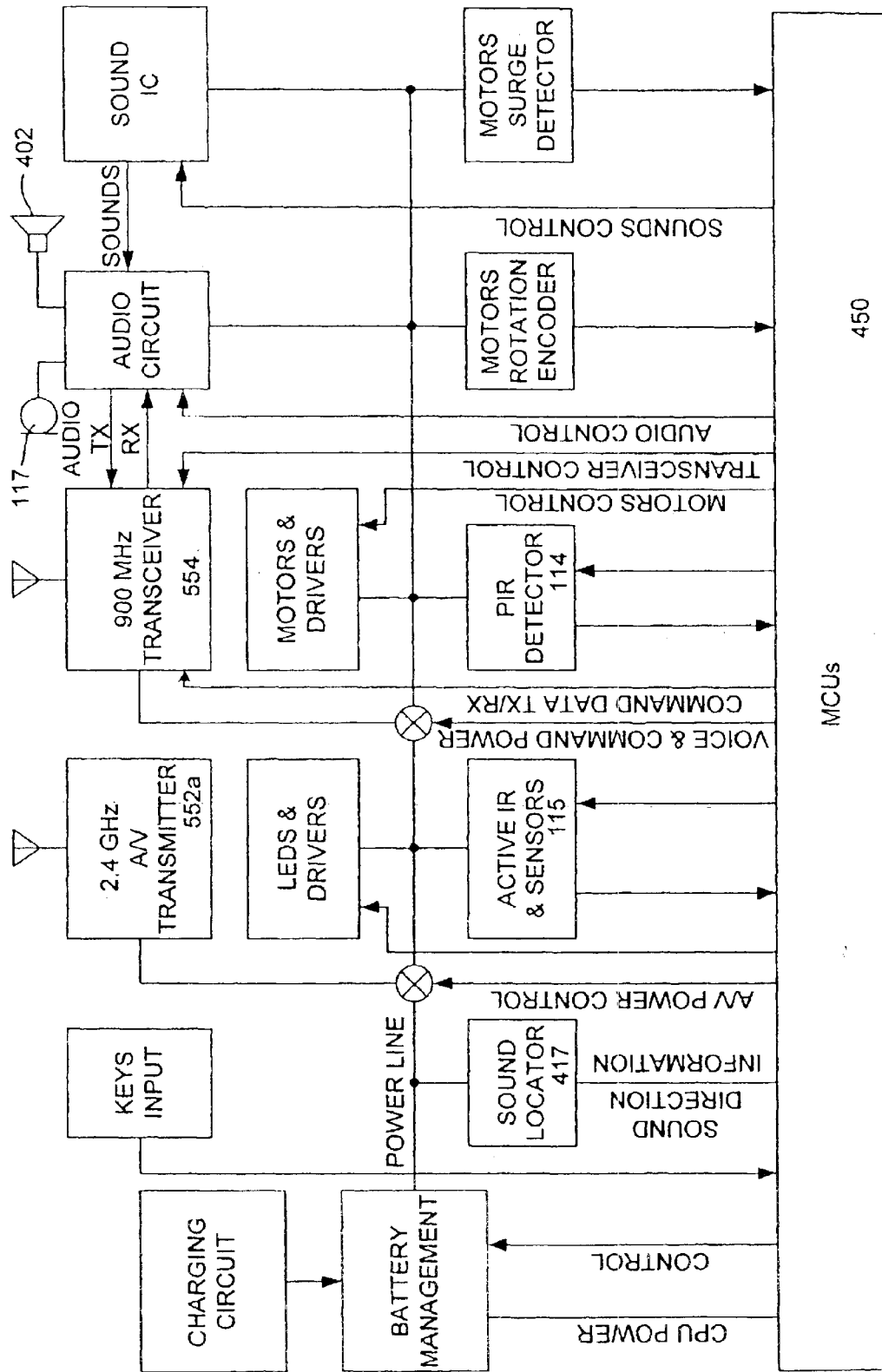

FIG. 16

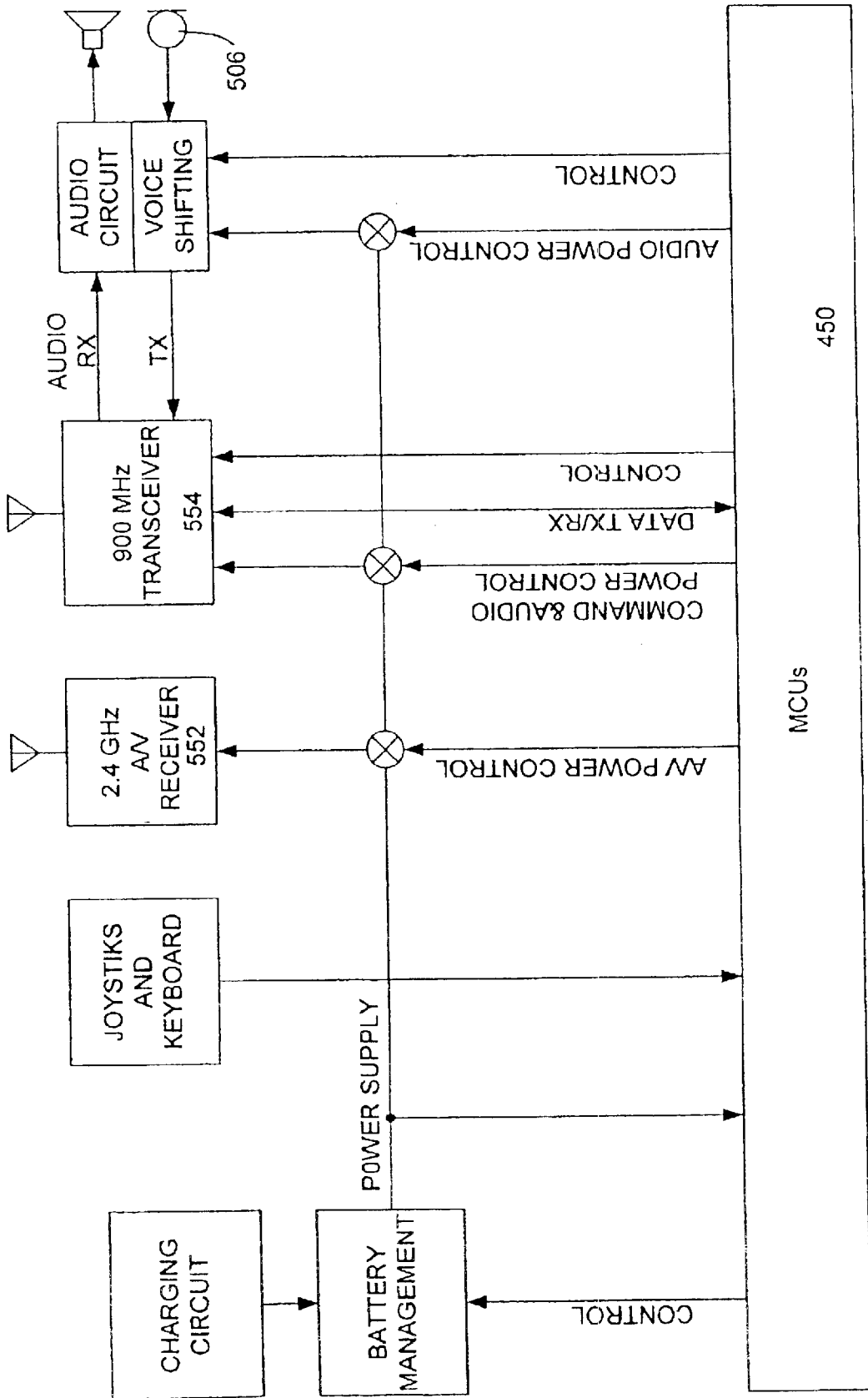

FIG. 17

ROBOT CAPABLE OF DETECTING AN EDGE

PRIORITY CLAIM

This application is a divisional of, and claims priority to, U.S. patent application Ser. No. 10/284,110, filed Oct. 30, 2002, now U.S. Pat. No. 6,611,734, entitled "Robot Capable of Gripping Objects", which is a divisional of, and claims priority to, U.S. patent application Ser. No. 09/881,420, filed Jun. 14, 2001, entitled "Multi-Function Robot with Remote and Video System", now U.S. Pat. No. 6,507,773.

FIELD OF THE INVENTION

The present invention relates generally to a robot that can be manipulated remotely by a user or operate autonomously. More particularly, the robot can detect and avoid bumping into obstacles and traveling off an edge, thus allowing the robot to interact with objects in a room. Further, the robot can be manipulated remotely without the user requiring a line-of-sight with the robot. All of these features allow the robot to provide various security measures.

BACKGROUND

Remote controlled robots allow users to manipulate the robot using a remote control device, allowing the user to move the robot and perform simple tasks. Typically, to be able to see where the user is moving the robot, the user must have a line of sight with the robot. Otherwise, the user cannot see where the robot is and risks damage to the robot by driving it off an edge or colliding with an object.

Therefore, there is a need for a remote control device to have a video screen allowing the user to see the area in front of the robot. With a video screen on the remote control device, a user can move the robot in areas that are not in the user's line of sight. Thus, the robot can be moved into more areas.

Additionally, a robot traditionally cannot interact with people on its own. The user must typically manipulate every action of the robot. Therefore, there is a need for a robot to operate autonomously and interact with people it encounters. To accomplish this, a robot must have the ability to detect moving and stationary objects in the immediate vicinity. To safely operate autonomously, a robot must also have an edge detection system so as to not travel over an edge and damage itself.

Some robots have video cameras, enabling a user to view the area in front of the robot. However, typically the user may only view the image from the video camera through a computer. Therefore, there is a need for a hand-held remote control device with a video screen that a user can easily transport.

SUMMARY OF THE INVENTION

The present invention is a multi-function robot. The robot can operate autonomously or be manipulated remotely by a remote control device. To interact with people in a room, the robot is designed with two arms, two legs, eyes, a mouth, and a head. The arms can rotate in several positions and further contains a hand-grip device. The hand-grip device allows the robot to hold and release objects. The legs of the robot are designed to move the robot throughout a room. The mouth and eyes of the robot allow it to communicate with people in the room and provide emotions.

To operate autonomously the robot has multiple sensors to avoid bumping into obstacles within the room and traveling

off an edge. The sensors include infrared devices located on the body of the robot and an edge detection element located in the legs of the robot. The robot also has several modes by which it can operate autonomously. For example, an automatic mode allows the robot to move autonomously throughout the room, detect people within the room, and interact with the people. The robot can also provide security to the household when it is the security mode. In security mode the robot can detect noise and send an alarm signal to the remote control device to alert the user that an object has been detected. The robot can also greet people when in the greet mode. Additionally, the robot may be placed in the monitor mode, which allows a user to remotely view objects in front of the object and hear sounds within the vicinity of the robot. Finally, the robot can be placed in the remote control mode which allows a user to remotely manipulate the robot.

To enhance the operation of the modes described above, the robot can display moods through lighting of its eyes and mouth. Depending on the mode the robot is operating from and the type of speech the robot is making, the eyes will change colors to express a different mood. Further, while the robot is speaking the mouth will display different patterns.

To operate manually, a remote control device is used to manipulate the robot remotely. The remote control device contains all the functions a user will need to manipulate the robot. For example, the remote control device contains a joystick, video display, a microphone, a transmitter/receiver, and several other controls to manipulate the robot. The joystick allows the user to translate motion of the robot in several directions. The video display allows the user to remotely view the area in front of the robot through the video camera on the robot. The user can also transmit his voice to the robot such that his voice is projected from the robot.

BRIEF DESCRIPTION OF THE DRAWINGS

FIG. 1 is a front perspective view of an embodiment of the robot of the invention with the left arm in a raised position and both hands in an open position;

FIG. 2 is a rear perspective view of the robot with the left arm in a raised position and both hands in an open position;

FIG. 3 is a left side view of the robot with the left arm in a raised position and the hand in an open position;

FIG. 4 is a front view of the robot with the left arm in a raised position and both hands in an open position;

FIG. 5 is a rear view of the robot with the left arm in a raised position and both hands in an open position;

FIG. 6 is a top view of the robot with the left arm in a raised position and both hands in an open position;

FIG. 7 is a front perspective view of the robot thereof with the left arm in a 90° raised position carrying a tray and the right arm in a 180° raised position carrying a tray;

FIG. 8 is a cutaway view of an arm of the robot illustrating the mechanism to open and close the hands of the robot;

FIG. 9 is a cutaway view of a leg of the robot illustrating the mechanism to rotate the arms;

FIG. 10 is a cutaway view of a leg of the robot illustrating the drive mechanism;

FIG. 11 is a cutaway view of the body of the robot illustrating the mechanism to rotate the rotatable platform;

FIG. 12 is a cutaway view of the mechanism to drive the scanning passive infrared sensor;

FIG. 13 is a perspective view of an embodiment of the remote control device of the invention;

FIG. 14 is a top rear perspective view of the remote control device;

FIG. 15 is a top view of the remote control device;

FIG. 16 is a block diagram for the controls of the robot; and

FIG. 17 is a block diagram illustrating the controls for the remote control device.

DETAILED DESCRIPTION

Referring now to FIGS. 1-7, the robot 100 contains a body 102, arms 104, legs 106, video device 122, mouth 126, eyes 128, light 118, microphones 117, active infrared emitter 115, a passive infrared scanner 114, and multiple sensors to assist the robot 100 from running into obstacles or traveling off an edge.

The arms 104 are connected with the body 102. The arms 104 can be positioned in multiple locations and further can be positioned in pre-set "serving" locations. As shown in FIG. 7, the two pre-set serving positions are at the 90° and 180° positions. Both arms 104 can be adjusted to either position independently. Further, to ensure that the arms 104 will not rotate when in either serving position, the arms 104 can be located so that the remote control 500 cannot activate the arms 104. Referring now to FIG. 9, the mechanism for rotating the arms 104 can be seen. The motor 180, via a flexible belt 181, drives gear 182, which drives gear 184, which drives gear 186, which drives gear 188, which drives gear 190. Gear 190 is attached to the arm 104. To lower the cost and complexity of the mechanism, gears 184, 186, and 188 are the same part. An optical emitter/receiver monitors the movement and location of gear 190 via a toothed wheel (not shown) attached coaxially to gear 190. Such a device is commonly referred to as an optical position encoding device throughout the industry. Therefore, it is known to one of ordinary skill in the art and does not need to be further described. The monitoring through the above described optical position encoding device allows the robot 100 to know the position of the arms 104. When the robot 100 is turned on, the arms 104 are calibrated by moving them through a range of motion that the robot 100 can track their position from the starting position.

To grip and hold an object, the arms 104 also contain a hand grip device. The hand grip device contains a first finger 110 and a second finger 108. As shown in FIG. 1, the first finger 110 is stationary and has cavities 112 for holding a serving device (See FIG. 7). The second finger 108 opens and closes to grip and release an object. However, one of ordinary skill in the art will appreciate that the second finger 108 maybe stationary while the first finger 110 opens and closes. A spring closure mechanism biases the second finger 108 in a closed position. As the mechanism is commonly known to one of ordinary skill in the art, the mechanism does not need to be further described. The spring closure mechanism will not apply more than five pounds of pressure to an object placed between the first finger 110 and the second finger 108. Limiting the pressure to five pounds will prevent damage to an object held between the first finger 110 and the second finger 108.

A separate motor operates to activate the second finger 108. Referring now to FIG. 8, a leadscrew 152 on the shaft of the motor 150 turns gear 154, which turns gear 156, which turns gear 158. Each stage reduces the RPM and increases torque. The gear 158 has a pin on its underside which pulls a steel linkage which is attached by springs to the lever arms 109 of the second finger 108. As the steel linkage is commonly known to one of ordinary skill in the art, the steel

linkage does not need to be further described. This double-spring per can thus be forced open or shut against a spring force without damage to the mechanism.

The legs 106 are also connected with body 102. The legs 106 provide lateral support to keep the body 102 elevated and substantially perpendicular to the ground. The legs 106 also provide the ability for the robot 100 to move about. Each leg 106 contains a drive mechanism 300 to move the robot 100. The drive mechanism 300 located in each leg 106 can move the robot forward, reverse, left and right and both forward and reverse directions, and can spin the robot in place by controlling the rotation of the center wheel 138. Counters on each drive mechanism 300 control the straight forward motion with the two drive mechanisms 300 in synchronization.

The drive mechanism 300 is illustrated in FIG. 10. The motor 306 has an attached pulley 307 to drive the pulley 302 via the flexible belt 304. The pulley 302 has a small gear which also drives the center wheel 138. The small gear is a common toothed wheel which is commonly known to one of ordinary skill in the art. The flexible belt 304 provides tolerance for heavy loads which would otherwise damage a motor or gear train. Also, the flexible belt 304 reduces noise over using hard gears for first-stage reduction. A counter (not shown) mounted on the gear 310 counts the rotation of the center wheel 138 via an attached toothed wheel for indexing and monitoring speed. As the counter is a device which is commonly known to one of ordinary skill in the art, it will not be described further. Other optical position encoding devices can be used with wheel 138 as is known in the art. As the center wheel 138 is the only wheel propelled by the drive mechanism 300, the movement of the robot 100 is dependant solely on the center wheel 138. The front end wheel 120 and rear end wheel 121 rotate freely upon contact with a surface and provide lateral support to keep the body 102 substantially perpendicular with the ground.

The robot 100 has several sensors to prevent the robot 100 from running into obstacles and traveling off an edge. The sensors includes ambient light sensors 123, active infrared emitters 115, passive infrared sensor 114, motor sensors (not shown), a tilt sensor and an edge sensor (not shown but described later). As the motor sensor and the tilt sensor are commonly known to one of ordinary skill in the art, they will not be described herein.

The ambient light sensor 123 determines if the ambient area in front of the robot 100 is below a minimum illumination. If the intensity of the ambient light is not enough to view objects through the video display 504 of the remote control 500 without additional light, an infrared mode of the video device 122 will be activated, allowing a user to see objects at night.

To help the robot 100 avoid bumping into obstacles and traveling off an edge, the robot 100 contains active infrared emitters 115, a passive infrared (PIR) sensor 114 and four edge sensors 107, described hereafter. Avoiding obstacles is an important function of the robot 100 so that the robot 100 can operate autonomously. Each leg 106 contains three active infrared sensors 115. The PIR sensor 114 is located on the front of the body 102. The edge sensors 107 are located in the legs 106, whereby one sensor is located in each toe and heel of the leg 106.

The robot 100 contains six active infrared emitters 115, with three in each leg 106. Signals emitted by the active infrared emitters 115 are detected by signal receiving device located within housing 116. The three active infrared emitters 115 located in each leg 106 emits a signal at a different

angle. The pattern is identical in both the legs **106**. For example, if the three active infrared emitters **115** are aligned in a vertical pattern, the top emitter would emit a signal in a substantially 90° angle from the surface of leg **106**. Additionally, the middle emitter would emit a signal approximately 30° offset towards the ground from the top emitter. The bottom emitter would emit a signal approximately 30° offset towards the ground from the middle emitter. Since each emitter **115** emits a signal at a different angle, the signal will reflect off an object at different places in a room.

This pattern of active infrared emitters **115** allows for each emitter **115** to detect an object at a different distance or time. For example, since the top emitter emits a signal substantially parallel to the ground, the top emitter will indicate that an object is in front of the robot **100**, but at a distance far away. As the middle emitter emits a signal toward the floor, the middle emitter will indicate that an obstacle is in front of the robot **100** and closer than if the top emitter would have detected the object. Similarly, as the bottom emitter substantially emits a signal toward the ground, the top or middle emitter may not detect an object very close. Thus, the bottom emitter, by not receiving a signal, will indicate that an object is directly in front of the robot **100** and that the obstacle is very near, such as an edge.

Each active infrared emitter **115** emits a signal. However, only one emitter **115** emits a signal at a time. The six emitters **115** time share the signal receiving device. By only allowing one active infrared emitter **115** to send a signal at a time, the signal receiving device knows which emitter **115** sent the signal. Thus, the robot **100** can determine if the object is far away, near or immediately in front of it. Further, as the emitters **115** continuously emit a signal, the robot **100** can monitor and update the position of objects and edges. With three emitters **115** located on each leg **106**, the robot **100** can distinguish if the obstacle or edge is on the left or right side.

The PIR sensor **114** is a separate system from the active infrared emitters **115**. The PIR sensor **114** does not emit a signal. Instead, the PIR sensor **114** detects heat. Normally, a passive infrared sensor is not able to detect an object emitting heat if the object is stationary because a typical passive infrared sensor detects a change in temperature. However, the robot **100** can detect a stationary object that emits heat because the PIR sensor **114** is mounted in housing **116**, which continuously rotates through a range.

Referring now to FIG. **12**, the motor **250** has an attached pulley **252** to drive the pulley **256** via the flexible belt **254**. The pulley **256** drives the pulley **258**, which drives the pulley **260**, which drives the pulley **262**, which drives the housing **116**. Similar to the drive mechanism **300**, this drive belt provides tolerance for heavy loads and reduces noise over using hard gears. An optical emitter/receiver (not shown and similar to these described above) monitors the movement and location of the gear that drives the housing **116**. The PIR sensor **114** will detect heat signals as it moves through the range dictated by the housing **116**. For example, as the housing **116** rotates through its range, the temperature differential between the person and the surrounding environment will be detected by the PIR sensor **114**. The robot **100** will know the location of the person in relation to the robot **100** by the angle the housing **116** is at the moment the PIR sensor **114** detects the heat differential.

The edge detection system relies on feedback from the active infrared emitters **115**, the signal receiving device, and an edge detection element **107** located in leg **106**. The active

infrared emitters **115** sequentially send out signals as previously described. When the signal receiving device detects an edge from the signal emitted by an active infrared emitter **115**, the robot **100** will then slow down, thus allowing the edge detection element **107** in leg **106** to confirm that there is an edge. The edge detection element **107** is a leafswitch **111** connected with the front wheel **120** and the rear wheel **121**. As the robot **100** moves slowly forward, if the front wheel **120** or the rear wheel **121** travels a predetermined distance downward, the leaf switch **111** will close and complete a circuit to send a signal to the robot **100** that there is an edge. Thus, the robot **100** will not continue to travel in that direction. Instead, the robot **100** will change direction and continue to operate autonomously. The edge detection element **107** also serves as a backup to the active infrared sensors **115** ability to detect an edge. For example, the signals sent by the active infrared emitters **115** will not reflect from a black carpet. Therefore, the signal receiving device will not detect an edge. In this case, the edge detection element **107** will be the first and only method to detect an edge.

The motor sensors located within the body **102** monitor current surges to the motors to tilt the body **102**, rotate the arms **104**, rotate the rotating platform **124**, and drive the center wheel **138**. If a surge in current exceeds a minimum threshold, the robot **100** will notify the user by speaking from its vocabulary (e.g., “ouch,” “stop it,” “that hurts,” “that’s heavy,” etc.).

Robot **100** has several modes by which the robot **100** can operate. Several modes allow the robot **100** to operate autonomously, while other modes require a user to remotely manipulate the robot **100**. The mode settings include a remote control mode, a monitor mode, an automatic mode, a security mode, a greet mode and a demonstration mode.

When the automatic mode is selected, the robot **100** begins to move autonomously throughout the room. As explained above, the active infrared emitters **115** assist the robot **100** to avoid bumping into obstacles and traveling off an edge. While the robot **100** is moving throughout the room it will occasionally speak from the auto vocabulary, depending on sensor input. Simultaneously, the PIR sensor **114** scans the area in front of the robot **100** to detect a heat source. When the robot **100** detects a heat source, the rotatable platform **124** will turn toward the object and speak from its “roam” vocabulary (e.g., “Nice to see you again,” “How are you.”, etc.)

The motor mechanism which drives the rotatable platform **124** is shown in FIG. **11**. A motor has an attached pulley **200** to drive the pulley **202** via flexible belt **204**. As the motor is commonly known to one of ordinary skill in the art, the motor will not be described further. The pulley **202** drives the pulley **206**, which drives the pulley **208**, which drives the pulley **209**, which drives the pulley **210**, which drives the pulley **212**. The pulley **212** drives the rotatable platform **124**. The pulleys **208**, **209** and **210** are the same to lower the cost and complexity of the mechanism. The motor mechanism allows the rotatable platform **124** to rotate either left or right, up to 135°.

The robot **100** can also detect the location of a noise. Three microphones **117** are placed around the robot **100** at approximately 120° angles apart from each other. The microphones **117** can detect the phase difference in a sound detected so that the robot **100** can determine what direction the sound originated from. When a noise is detected, the robot **100** will turn its rotatable platform **124** towards the object as if it is speaking directly to the object.

The robot **100** can also provide security to a household. When the security mode is selected, the robot **100** stands still with minimum power consumption. When the microphones **117** on the robot **100** detect noise above a minimum threshold, the rotatable platform **124** turns towards the noise source and the PIR sensor **114** begins to scan. If a heat source is detected, the robot **100** turns on the light **118**, the rotatable platform **124** turns towards the heat source, and the robot **100** makes an announcement from the security vocabulary. Further, the robot sends an alarm signal to the remote control device **500** to alert a user that an object has been detected.

Robot **100** can also greet people. When the greet mode is selected, the robot **100** scans with the PIR sensor **114** to search for a detectable object (e.g., a person). If a heat source is detected, the robot **100** turns the rotatable platform **124** towards the source and makes an announcement from the greeting vocabulary.

Robot **100** can also demonstrate many of its functions through a pre-programmed routine. When the demonstration mode is selected, the robot **100** performs several motions to display various functions that the robot can operate. For example, the robot will rotate its arms **104** through the full range of motion, tilt its body and speak.

The robot **100** can also be manipulated remotely by a user. When the remote control mode is selected, the robot **100** is manipulated remotely by a user via a remote control device **500** (See FIG. 13) or via the Internet.

Finally, when the monitor mode is selected, the drive mechanism **300** is disabled so that the robot cannot move. However, the robot **100** can transmit audio and video signals to the remote control device **500** so that a user can remotely view objects in front of the robot and hear sounds within the vicinity of the robot **100**. A user is not limited to the range of remote control device **500** if the user is remotely manipulating the robot **100** via the Internet.

The robot **100** can also display moods to enhance or compliment the specific mode the robot **100** is operating in. The different moods are expressed by the eyes **128** and the mouth **126**. The eyes **128** allow the robot **100** to express moods through different combinations of lighting. The eyes **128** contain several lights where each light emits at least one color. The lights maybe arranged in several combinations. The combination of lights may be activated to display at least one color. Specifically, the lights within eyes **128** consist of one blue light, two amber lights and two red lights. The preferred embodiment for the eyes **128** is such that the blue light is positioned in a forward position while the two red and two amber lights are positioned in a rearward position. A reflective surface is placed in the eyes **128** facing the amber and red lights so that the amber and red lights emit light in a forward direction to blend with the blue light. The color emitted from the eyes **128** can be any combination of the blue, amber, and red lights. The combination of lights activated depends on whether the robot **100** is in the night light mode, the monitor mode, the security mode, the remote control mode, the automatic mode or the greet mode.

When the robot **100** is in the night light mode, two amber and two red lights are activated and emitted from the eyes **128**. When the robot **100** is in the monitor mode, one amber light is activated and emitted from the eyes **128** at all times. When the robot **100** is in the security mode, the lights activated depend on whether the robot **100** is talking or not talking. When the robot **100** is not talking, one blue light is activated and emitted from the eyes **128**. When the robot **100** is talking, one blue light and two red lights are activated and emitted from the eyes **128**.

When the robot is the remote mode, automatic mode or greet mode, the lights activated depend on whether the robot **100** is not talking, talking, tired, or tired and talking. When the robot **100** is not talking in either of these modes, one blue light and one amber light are activated and emitted from the eyes **128**. When the robot **100** is talking, one blue light and two amber lights are activated and emitted from the eyes **128**. When the robot **100** is tired, one blue light and one red light is activated and emitted from the eyes **128**. Lastly, when the robot **100** is tired and talking, one blue light and two red lights are activated and emitted from the eyes **128**.

To compliment all speech, the robot **100** also has a mouth **126** to express emotions. The mouth **126** consists of several rows of red LED's that can be individually activated. Depending on the sensor input and vocabulary spoken, the robot **100** can demonstrate emotions such as a smile, a frown, puzzled, surprise, concentration and thinking. When the robot **100** is speaking, the LED's continuously change in pattern.

Another feature of robot **100** is a low battery indicator **139** (See FIG. 2). The low battery indicator **139** contains five rectangular LED's on the back panel of the robot **100**. When the robot **100** is fully charged, all five LED's are lighted. When the power level is down to one lighted LED, the robot **100** has a vocabulary to indicate that the power is low and the robot **100** needs recharging. As the robot **100** detects that the battery becomes discharged, the robot **100** will reduce its functions to preserve power in the following order: first, the video functions; then, the audio functions; then, the locomotion functions will be eliminated. The remote control device **500** also has a low battery circuit which includes an audio power display and power cutoff. The power cutoff function is very important as lead-acid batteries will last through many more discharge cycles if they are not fully discharged with each use.

The control block diagram for the robot **100** is shown in FIG. 16. As shown, there are several microcontroller units (MCU) **400** that coordinate all the functions of the robot **100**. The MCU **400** consists of several, independent integrated circuits to control different functions of the robot. As explained above and illustrated by FIG. 16, the active infrared emitters **115** and the PIR sensor **114** are independently controlled.

Referring now to FIG. 13, the remote control device **500** is used to manipulate the robot **100** remotely. The remote control device **500** is a separately powered device from the robot **100**. An on/off button **328** may be depressed to turn the remote control device **500** on and off. The remote control device **500** contains a joystick **502**, video display **504**, a microphone **506**, a transmitter/receiver **508** and several controls by which a user can manipulate the robot (which will be disclosed later in this application). The joystick **502** is at a height suitable for use with the single thumb of a user. The joystick **502** has eight compass points to translate motion of the robot **100**. The eight compass points include left forward, straight forward, right forward, spin left, spin right, left backward, straight backward, and right backward. When any forward position of the joystick **502** is engaged for more than three seconds the robot **100** will increase speed in the direction engaged, limited by a maximum speed.

The video display **504** allows the user to remotely view the area in front of the robot **100**. The robot **100** has a video device **122** which is located on the rotatable platform **124**. The image transmitted by the video device **122** is displayed in the video display **504**. By turning the rotating platform

124 or moving the robot 100 in a different direction, a user may see a different area of the room. The contrast knob 536 helps the user adjust the contrast of the video display 504 to optimize the image displayed. To conserve battery power, the video display 504 may be turned off by depressing the display power button 526. Even though the video display 504 is off, the robot 100 can still be manipulated by the remote control 500.

The microphone 506 allows a user to transmit his voice to the robot 100 so that the user's voice is projected from the robot 100. The remote control 500 has three voice input buttons 510, 512 and 514. By depressing and holding down any of the voice input buttons, a user may speak into the microphone 506 and the voice will be transmitted to the robot 100. The voice input button 510 allows the user's voice to be transmitted to the robot 100. The voice input buttons 512 and 514 activate an audio circuit which distorts the user's voice before it is transmitted to the robot 100. Thus, the user's voice projected from the robot 100 is disguised. The voice input buttons 512 and 514 distort the user's voice in a different manner. In addition to transmitting your voice to the robot 100, the remote control 500 can receive sounds detected by the robot 100. The microphones 117 on the robot 100 detect surrounding noise and transmit it back to the remote control 500 so that a user may hear them. The volume control knob 534 allows the user to turn the volume of the noise up or down.

The transmitter/receiver 508 has two antennas. First, a 2.4 GHz antenna 552 sends audio and video signals from the robot 100 to the remote control device 500. The second antenna is a 900 MHz antenna 554 that sends control signals from the remote control device 500 to the robot 100. 900 MHz and 2.4 GHz are common frequencies by which many household devices operate on. To insure that the remote control device 500 will not interfere with other devices in the house (e.g., a cordless phone) each antenna has additional channels which the user may select. Specifically, the 2.4 GHz antenna 552 has two channels and the 900 MHz antenna 554 has three channels a user may select to avoid interfering with other similar devices in the house (each cordless phone).

The robot 100 can perform many functions. Several of the functions include tilting the body 102, rotating the arms 104, gripping an object, rotating the rotatable platform 124, and moving the robot 100. The body 102 can tilt 180° forward 30° rearward. Tilting the body 102 forward is accomplished by pressing control button 550. Tilting the body 102 rearward is accomplished by pressing control button 538. By pressing and holding either button, the body 102 will continue to rotate, stopping when the button is released or the body 102 reaches its maximum tilt angle.

The arms 104 can rotate through many positions, including two "serve" positions which are located at the 90° and the 180° positions from rest (See FIG. 7). By depressing briefly the up direction button 540 or the down direction button 548, the arms 104 will increment to the next preset position in the direction indicated. Longer button depressions will control motion of the arms 104 manually, stopping at a position when the button is released. Both the up direction button 540 and the down direction button 548 are divided into a left and right half, whereby the right half controls the right arm 104 and the left half controls the left arm 104. Thus, both arms 104 can be controlled independently of the other.

To grip an object, the second finger element 108 can move to a width opening of approximately 75 millimeters away from the first finger element 110. The second finger element 108 can be opened and closed via the hand control button 544 on the remote control 500. Similar to the direction

buttons, by quickly depressing the hand control button 544, the second finger element 108 will move to the next preset position. As the motor 150 that controls the movement of the second finger element 108 only rotates in one direction, the second finger element 108 simply cycles through an open and close position. By holding down the hand control button 544 is also divided into a left and right portion. The left half of the hand control button 544 controls the left hand and the right half of the hand control button 544 controls the right hand grip. Thus, the hand grips can be controlled independently. Thus, holding down the hand control button 544 cycles the second finger element 108 through the entire range of motion. The second finger element 108 is also clutched in both directions.

The serving positions of the arms 104 can be automatically accessed by depressing serving button 530. Each time the serving button 530 is depressed, the following positions of the arms 104 are achieved: First, the right arm 104 rotates to a 90° position. Second, the right arm 104 rotates to a 180° position. Third, the left arm 104 rotates to a 90° position. Fourth, the right arm 104 returns to the 90° position. Fifth, the right arm 104 returns to the 180° position. Sixth, the left arm 104 rotates to the 180° position.

The rotatable platform 124 can also be controlled remotely by depressing the left rotate button 542 and the right rotate button 546. The rotatable platform 124 can rotate approximately 135° in either direction. By intermittingly depressing either the left control button 542 or the right control button 546 the rotatable platform 124 will turn incrementally. If the rotatable platform 124 is not at the center position when the drive control is activated, the rotatable platform 124 will automatically return to the center/forward position. This function allows the user to view where the robot 100 is traveling.

The remote control 500 can also be used to select which mode the robot 100 will operate. When the mode button 516 is selected, the robot 100 enters into the automatic mode. When the mode button 518 is selected, the robot 100 enters the monitor mode. When the mode button 520 is selected, the robot enters the security mode. When the mode button 522 is selected, the robot 100 enters the greet mode. When the mode button 524 is selected, the robot 100 enters the remote control mode. If the robot 100 is operating in an autonomous mode, the user may depress the mode button 524 to end the autonomous mode and then the robot 100 can be controlled again by the remote control device 500.

The remote control device 500 can also activate the light 118. If it is dark within the room and a user wishes to provide additional light in front of the robot 100, the user may do so by depressing the light button 532. By depressing the light button 532 once, the light 118 is turned on. Depressing the light button 532 a second time activates the bright setting of the light 118. Depressing the light button 532 a third time turns the light 118 off.

Referring now to FIG. 17, a block diagram illustrates the controls of the remote control 500. The microcontroller units (MCU) 450 independently receive signals from the keyboard and joystick. These signals are then sent to the 900 MHz transceiver 554 for transmitting to the robot 100. FIG. 17 also shows that signals received by the microphone 506 are sent to the voice shifting device and then to the 900 MHz transceiver 554 and finally transmitted to the robot 100.

There are several controls which are located on the robot 100 and not on the remote control 500. For example, a user may press and hold the message button 142 located on the back of the robot 100 to record a message for up to fifteen seconds. Once the message is recorded, the message button 142 may be pressed again to hear the recorded message played back. In addition, the find remote button 143 sends an announce signal to the remote control 500 whereby the

11

remote control **500** will make a noise allowing the user find the remote control device **500**. The power button **144** is also located on the back of the robot **100**. The power button **144** can be pressed to turn the robot **100** on and off. Further, if the user presses and holds the power button **144** for approximately two seconds the robot will enter the demonstration mode.

The foregoing description of preferred embodiments of the present invention has been provided for the purposes of illustration and description. It is not intended to be exhaustive or to limit the invention to the precise forms disclosed. Obviously, many modifications and variations will be apparent to the practitioner skilled in the art. The embodiments were chosen and described in order to best explain the principles of the invention and its practical application, thereby enabling others skilled in the art to understand the invention for various embodiments and with various modifications that are suited to the particular use contemplated. It is intended that the scope of the invention be defined by the following claims and their equivalence.

What is claimed is:

1. A robot capable of detecting an edge, comprising:
 - a body;
 - at least one leg, connected to the body, including a driving mechanism to move the robot; and
 - an edge detection system including:
 - at least one infrared emitter;
 - a signal receiving device to detect a signal emitted by the infrared emitter after the signal has been reflected; and
 - at least one edge detection element;
 wherein the edge detection system is adapted to detect an edge based on feedback received from the signal receiving device; and
 - wherein the driving mechanism slows down after an edge has been detected in response to the feedback received from the signal receiving device, thereby allowing the edge detection element to confirm that there is an edge.
2. The robot of claim 1, wherein the edge detection element indicates that there is an edge if an end wheel of the robot travels a predetermined distance downward.
3. The robot of claim 1, wherein the edge detection element comprises:
 - a first switch that closes when a front end wheel travels the predetermined distance downward; and
 - a second switch that closes when a rear end wheel travels the predetermined distance downward.
4. The robot of claim 3, wherein each of the first switch and the second switch comprise a leaf switch.
5. The robot of claim 4, wherein the closing of the first switch completes a first circuit causing a signal to be sent to the robot indicating that an edge was detected near the front end wheel.
6. The robot of claim 5, wherein the closing of the second switch completes a second circuit causing a signal to be sent to the robot indicating that an edge was detected near the rear end wheel.
7. The robot of claim 3, wherein:
 - closure of the first switch causes the driving mechanism to move the robot backward; and
 - closure of the second switch causes the driving mechanism to move the robot forward.
8. A robot capable of detecting an edge, comprising:
 - a body;
 - a left leg and a right leg to keep the body elevated;
 - the right leg including:
 - a right driving mechanism;
 - a right center wheel, rotated by the right driving mechanism;

12

- a right front end wheel;
 - a first edge detection switch that closes in response to the right front end wheel moving at least a predetermined distance downward;
 - a right rear end wheel; and
 - a second edge detection switch that closes in response to the right rear end wheel moving at least a predetermined distance downward;
- the left leg including:
- a left driving mechanism;
 - a left center wheel, rotated by the left driving mechanism;
 - a left front end wheel;
 - a third edge detection switch that closes in response to the left front end wheel moving at least a predetermined distance downward;
 - a left rear end wheel;
 - a fourth edge detection switch that closes in response to the left rear end wheel moving at least a predetermined distance downward;
- wherein the left and right driving mechanisms move the robot in a direction away from a detected edge based on which of the first, second, third and fourth switches close.
9. The robot of claim 8, wherein each the edge detection switch comprises a leaf switch.
 10. The robot of claim 9, further comprising an infrared transceiver subsystem to detect an edge, wherein the left and right driving mechanisms will slow down movement of the robot in response to the infrared transceiver subsystem indicating detection of an edge, thereby allowing one of the edge detection switches to confirm that there is an edge.
 11. The robot of claim 8, wherein the infrared transceiver subsystem includes:
 - at least one infrared emitter; and
 - a signal receiving device to detect a signal emitted by the infrared emitter after the signal has been reflected.
 12. The robot of claim 8, wherein the right front and rear end wheels and the left front and rear end wheels rotate freely upon contact with a surface.
 13. The robot of claim 8, wherein:
 - the right front and rear end wheels are each pivotally mounted relative to the right center wheel; and
 - the left front and rear end wheels are each pivotally mounted relative to the left center wheel.
 14. An edge detection system for preventing a moving robot from traveling off an edge, including:
 - a infrared transceiver subsystem for detecting an edge; and
 - an edge detection element to confirm whether the infrared transceiver subsystem actually detected an edge, and to detect an edge not detected by the infrared transceiver subsystem;
 - the edge detection element comprising a switch that closes in response to a wheel traveling a predetermined distance downward.
 15. The system of claim 14, wherein detection of an edge by the infrared transceiver subsystem causes movement of the robot to slow down, thereby providing more time for the edge detection element to confirm whether the infrared transceiver subsystem actually detected an edge.
 16. The system of claim 14, wherein closing of the switch causes the robot to not continue in its current direction of travel.
 17. The system of claim 14, wherein closing of the switch causes the robot to change its direction of travel.
 18. The system of claim 14, wherein the edge detection switch comprises a leaf switch.
 19. The system of claim 14, wherein the closing of the switch completes a circuit causing a signal to be sent to the robot indicating that an edge was detected.

20. The system of claim 14, wherein the infrared transceiver subsystem includes:
 at least one infrared emitter; and
 a signal receiving device to detect a signal emitted by the infrared emitter after the signal has reflected off a surface. 5

21. A robot capable of detecting an edge, comprising:
 a driving mechanism to move the robot along a surface; and
 an edge detection system including:
 a plurality of infrared emitters each directed at a different angle with respect to the surface, the emitters alternately emitting signals such that only one of the emitters emits a signal at one time; 10
 a signal receiving device to detect signals emitted by the infrared emitters after the signals have been reflected; and 15

wherein the edge detection system is adapted to detect an edge based on feedback received from the signal receiving device.

22. The robot of claim 21, wherein the driving mechanism slows down after an edge has been detected in response to the feedback received from the signal receiving device. 20

23. The robot of claim 22, further comprising:
 at least one edge detection element to detect an edge not detected by the edge detection system.

24. The robot of claim 23, further comprising:
 at least one edge detection element to confirm a detection of an edge by the edge detection system. 25

25. A robot capable of detecting an edge, comprising:
 a body with a first portion that is adapted to be located proximal to the ground and a second portion that is adapted to be located distal from the ground; 30
 a motor that can move the body;
 an edge detection system including:
 at least one infrared emitter;
 a signal receiving device that can detect a signal emitted from the infrared emitter after the signal has been reflected; and 35
 wherein one of the infrared emitter and the signal receiving device is located more adjacent to the second portion of the body than is the other of the infrared emitter and the signal receiving device. 40

26. A robot capable of detecting an edge, comprising:
 a body with a first portion that is adapted to be located proximal to the ground and a second portion that is adapted to be located distal from the ground; 45
 a motor that can move the body;
 an edge detection system including:
 a plurality of radiation emitters;
 a signal receiving device that can detect radiation emitted from the emitters after the signals have been reflected; and 50
 wherein each emitter is directed at a different angle with respect to the ground when the first portion of the body is located proximate to the ground.

27. The robot of claim 26, wherein only one of the emitters emits a signal at a time to allow the signal receiving device to know which emitter sent a signal whose reflection is detected. 55

28. The robot of claim 27, wherein the plurality of emitters alternately emit signals.

29. The robot of claim 27, wherein the plurality of emitters emit pulses of radiation. 60

30. The robot of claim 27, wherein the plurality of emitters emit radiation signals at different intervals.

31. A robot capable of detecting an edge, comprising:
 a structure including a lower portion, from which extends 65
 at least one wheel, and an upper portion extending above the lower portion;

a motor that can rotate the at least one wheel to thereby move the structure;

an edge detection system located in the upper portion of the structure, the edge detection system including:
 a plurality of radiation emitters each emitting radiation at a different angle and a different time with respect to one another; and
 a signal receiving device that can detect signals emitted from the emitters after the signals have been reflected.

32. A robot capable of detecting an irregularity, comprising:
 a body with a first portion which is adapted to be located proximal to the ground and a second portion which is adapted to be located distal from the ground;
 a motor that can move the body;
 an irregularity detection system including:
 at least one radiation emitter;
 a signal receiving device that can detect a signal emitted from the one radiation emitter after the signal has been reflected off an irregularity; and
 wherein one of the radiation emitter and the signal receiving device is located more adjacent to the second portion of the body than is the other of the radiation emitter and the signal receiving device.

33. The robot of claim 32, wherein to the irregularity detection system the lack of a detected signal can indicate a drop off.

34. A robot capable of detecting an edge, comprising:
 a motor that can move the robot;
 an edge detection system, including:
 a left plurality of radiation emitters each directed at a different angle with respect to one another; and
 a right plurality of radiation emitters each directed at a different angle with respect to one another;
 a signal receiving device that can detect a signals emitted from the emitters after the signals have been reflected;
 wherein only one of the emitters, in both the first and second plurality of emitters, emits a signal at a time to allow the signal receiving device to know which emitter sent a signal whose reflection is detected.

35. The robot of claim 34, wherein the robot can detect a general distance of an irregularity and whether the irregularity is located generally left or right of the body based on detected signals that have been reflected.

36. The robot of claim 25, wherein at least one of a detection or a signal or a lack of a detection of a signal is communicated to a micro-controller unit that controls the motor.

37. The robot of claim 26, wherein at least one of a detection or a signal or a lack of a detection of a signal is communicated to a micro-controller unit that controls the motor.

38. The robot of claim 31, wherein at least one of a detection or a signal or a lack of a detection of a signal is communicated to a micro-controller unit that controls the motor.

39. The robot of claim 32, wherein at least one of a detection or a signal or a lack of a detection of a signal is communicated to a micro-controller unit that controls the motor.

40. The robot of claim 34, wherein at least one of a detection or a signal or a lack of a detection of a signal is communicated to a micro-controller unit that controls the motor.